

FILE COPY

36° 15'
116° 45'

CALIF. 324

346
47 NEV

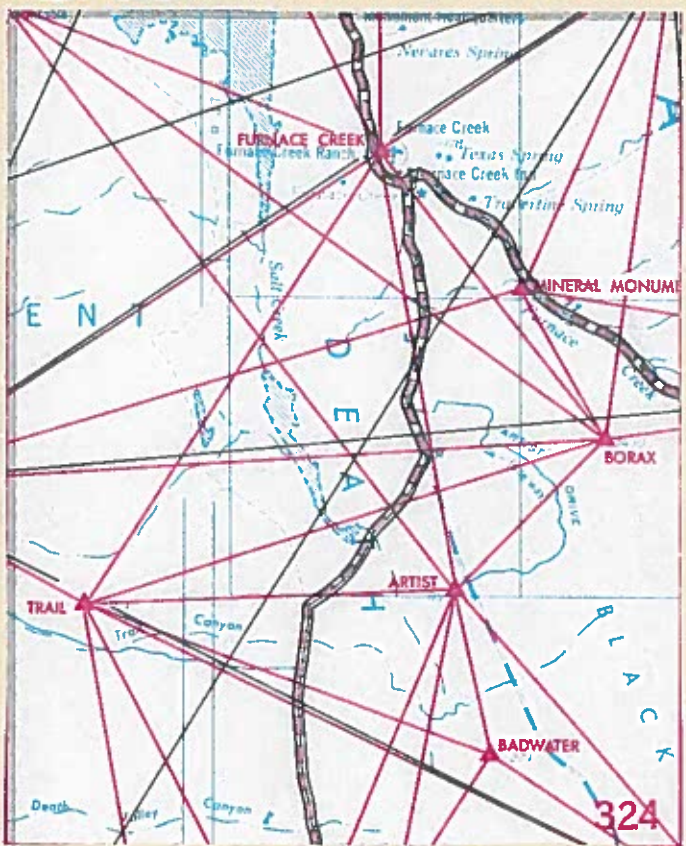

301

36° 15'

116° 45'

36°15'
116 45

CALIFORNIA

324

INDEX

<u>Station</u>	<u>Project</u>
Artists	-- (M)
<i>Destroyed</i> -Badwater	-- (M)
Borax	-- (M)
Furnace Creek	-- (M)
Mineral Monument	-- (M)
Trail	-- (M)

(M) = Multilith

X - U
Y

ARTISTS	36	19	37.0370	116	50	9360	2638125.43	368911.64
BADWATER	36	16	41.2590	116	4			
	36	16	41.2590	116	49	13.3510	2642421.57	351229.66
BORAX	36	22	20.2850	116	46	39.8520	2654193.44	385790.82
FURNACE CREEK	36	27	27.9060	116	51	39.5940	2628994.10	416333.49
MINERAL MONUMENT	36	25	12.3080	116	48	40.8660	2643903.14	402954.15
TRAIL	36	19	21.8240	116	58	14.3970	2597788.78	366491.69

UNITED STATES
DEPARTMENT OF THE INTERIOR
GEOLOGICAL SURVEY

THIRD-ORDER TRIANGULATION
North American Datum of 1927

FURNACE CREEK QUADRANGLE
CALIFORNIA 324
N3615-W11645/15

FILE COPY

- Inyo County
Edition of 3/1/57
- Numbered lines indicate listed azimuths and distances to the following stations not on the quadrangle:
1. C&GS BM "W 680 1943"
 2. Bennett
 3. Agur (C&GS)
 4. Poison
 5. Trianglum
 6. Boundary (USGS) (C&GS)
 7. Echo(C&GS)
 8. Pyramid Peak (C&GS)
 9. Dante(USGS)(C&GS)

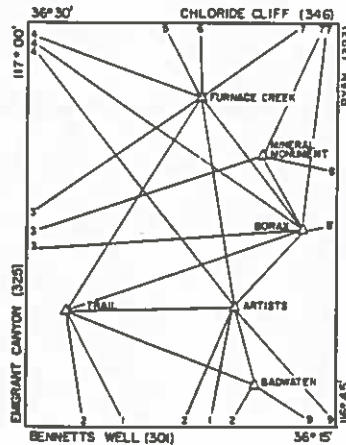

Books: PH 129-130

ARTISTS Inyo County CALIFORNIA

J. A. Lyon, 1949

Located about 11 mi. N. of Bennetts Well, 9 mi. S. of Furnace Creek Ranch on the highest part of a long low hill running E. and W.

Notes: Copied from C&GS reconnaissance description.

To reach from Furnace Creek Inn, drive 0.1 mi. westward to rd. intersection; take the rd. S. down Death Valley for 6.3 mi. to rd. forks; continue on pavement 3.8 mi. to T-rd. with low ridge to right (fork left "Artista Drive"); turn right off rd. and go onto the ridge from S. side; on ridge continue to near its SW. end to highest point and station.

Station mark: Standard tablet stamped "ARTISTS 1949" set in 6-in. concrete post.

Reference mark No. 1: Standard tablet stamped "1", set in small outcrop, 36.39 ft. from station mark in azimuth 60°50'. (Elevation -87.231)

Reference mark No. 2: Standard tablet stamped "2", set in small outcrop, 40.04 ft. from station mark in azimuth 153°36'. (Elevation -87.493)

Elevation -85.009 ft. (Spirit leveling by J. C. Durbin, 1950)

Latitude: 36°19'37.037" Longitude: 116°50'00.936"

To Station	Azimuth	Back Azimuth	Feet
C&GS BM "W 680 1943"	11°12'48.8"	191°11'26.8"	58,479.1
Bennett	22 50 20.9	202 46 51.7	74,782.1
Trail	87 51 31.8	267 46 39.5	40,411.0
Poison	14 10 34.3	322 04 37.3	80,077.8
Furnace Creek	170 23 35.5	350 22 37.0	48,295.4
Borax	224 52 56.1	44 54 55.2	23,305.4
Dante(USGS)(C&GS)	318 43 00.2	138 46 52.4	48,725.2
Badwater	34 7 38 10.1	167 38 38.2	18,197.2

BADWATER **Destroyed** Inyo County CALIFORNIA

J. T. Long, 1949

Located about 14 mi. S. of Furnace Creek Inn, in center of area known locally as "The Salt Pools".

To reach from Furnace Creek Inn, drive S. on paved rd. toward Badwater for 11.0 mi. to rd. forks and sign "SALT POOLS" pointing W.; take right fork toward Salt Pools for 1.95 mi. to NW. side of graded area at end of rd. and station.

Station mark: Standard tablet stamped "BADWATER 1949", set in cement block.

Elevation -279 ft. (By Plane table levels)

Latitude: 36°16'41.259" Longitude: 116°49'13.351"

To Station	Azimuth	Back Azimuth	Feet
Bennett	32°46'41.8"	212°42'44.6"	60,824.3
Trail	110 10 40.6	290 05 20.3	47,172.1
Artists	167 38 38.2	34 7 38 10.1	18,197.2
Dante (USGS)(C&GS)	303 42 19.2	123 45 43.0	33,957.2

BORAX Inyo County CALIFORNIA

J. T. Long, 1949

Located about 10 mi. N. of Badwater, 6 mi. SE. of Furnace Creek Ranch on the highest point of top.

Note: Description by C&GS reconnaissance notes. (USGS occupation via helicopter.)

To reach from Furnace Creek Inn, drive along State Highway 190 towards Death Valley Junction for 4.9 mi. to unpaved rd. going S. (This is the 20 Mule Team Scenic Loop); turn onto this unpaved rd. for 2.0 mi. to a building on a bench; at foot of pitch turn right off rd. into wash. Back up right-hand wash (old rd. goes up left one) for about 1 mi. to very large boulder in wash; continue up wash 200 yds. to a fork; take left fork of wash for 75 yds. to sharp rise of 50 ft. in height; go around this to left (ropes are needed for packs here) and continue in the same direction past a prominent shaft of clay; continue ahead to a tunnel in bank on left; at tunnel turn right up broad wash; continue ahead until canyon opens broadly and a long, steep slope can be seen on right; climb to top of this slope and from this point cross a sloping basin; climb to top of steep smooth slope and station. A 1 1/2-hour pack.

Station mark: Standard tablet stamped "BORAX 1949" set in solid rock, 0.4 ft. below surface of ground.

Reference mark No. 1: Standard reference mark tablet stamped "NO 1" set in rock outcrop, 35.69 ft. from station mark in azimuth 130°38'.

Reference mark No. 2: Standard reference mark tablet stamped "NO 2" set in rock outcrop, 37.22 ft. from station mark in azimuth 232°16'.

V.A. elevation 2430 ft.

Latitude: 36°22'20.285" Longitude: 116°46'39.852"

To Station	Azimuth	Back Azimuth	Feet
Artists	44°54'55.2"	221°52'56.1"	23,305.4
Trail	72 26 12.2	252 19 20.6	59,617.8
Agur (C&GS)	86 08 47.1	265 59 02.4	80,849.5
Poison	125 31 22.9	305 23 26.2	80,509.1
Furnace Creek	111 48 04.0	321 45 06.1	39,598.3
Mineral Monument	150 22 51.4	330 21 39.6	20,012.8
Echo (C&GS)	187 32 05.8	7 32 56.7	53,428.0
Pyramid Peak (C&GS)	261 41 33.7	81 47 29.4	49,550.7

FURNACE CREEK Inyo County CALIFORNIA

J. A. Lyon, 1949

Located at Furnace Creek Ranch Airport.

To reach, go to intersection of runways at N. corner of jct.

Station mark: Standard tablet stamped "FURNACE CREEK 1949" set in concrete post projecting about 6 inches above ground.

Reference mark No. 1: A 4-in. iron pipe set in concrete serving as windsock, 7.35 ft. from station mark in azimuth 7°38'.

Elevation -151 ft. (By Plane table leveling)

Latitude: 36°27'27.906" Longitude: 116°51'35.592"

To Station	Azimuth	Back Azimuth	Feet
Trail	33°19'34.0"	213°15'39.8"	58,807.6
Agur (C&GS)	56 54 03.5	236 47 16.1	67,024.0
Poison	110 50 11.4	290 45 12.5	43,923.8
Trianglum	153 23 42.0	333 20 48.2	53,170.7
Boundary(USGS) (C&GS)	179 36 38.4	359 36 34.1	85,684.8
Echo(C&GS)	235 12 02.3	55 15 51.6	38,325.5
Borax	321 45 06.1	141 48 04.0	39,598.3
Artists	350 22 37.0	170 23 35.5	48,295.4

MINERAL MONUMENT Inyo County CALIFORNIA

A. E. Letey, 1949

Not Found '83

Located about 3.5 mi. SE. of Furnace Creek Ranch, in center of traffic circle on Zabriski Point.

To reach from Furnace Creek Ranch, drive SE. for 4.5 mi. toward Death Valley Junction on State Highway 190 to a sign reading "ZABRISKI POINT"; turn right and continue 0.2 mi. to station.

Station mark: A 3/4-in. brass rod and a brass plate set on top of a large concrete block in the center of a traffic circle.

Elevation 713 ft. (By Plane table leveling)

Latitude: 36°25'12.308" Longitude: 116°48'40.866"

Destroyed
See
photo's

CAL. ZONE 4
X=2,628,994.1
Y=416,333.5

FILE COPY

Not Found '83

MINERAL MONUMENT (continued)

Latitude: 36°25'12.308" Longitude: 116°48'40.866"

To Station	Azimuth	Back Azimuth	Feet
Aguer(C&GS)	72°06'03.9"	251°57'30.7"	74,367.2
Echo (C&GS)	205 23 24.1	25 25 27.0	39,378.4
Pyramid Peak(C&GS)	279 50 15.3	99 57 23.0	59,804.6
Borax	330 21 39.6	150 22 51.4	20,012.8

TRAIL Inyo County CALIFORNIA

J. A. Lyon, 1949

Located 12 mi. NW. of Bennetts Well, 11 mi. SW. of Furnace Creek Ranch on highest part of top of low hill.

Note: Copied from C&GS reconnaissance description.

To reach from Furnace Creek Inn, drive 0.1 mi. westward to rd. intersection; take the rd. S. down Death Valley and continue 6.1 mi. to a main rd. intersection; turn right as via "Bennetts Well" and continue 5.4 mi. to rd. intersection; turn right off main rd. at sign "TRAIL CANYON"; continue on Trail Canyon Road for 5 mi. to a sag on bush on right side of rd. Station is across wash and about 1 mi. From end of truck travel pack across wash and up a side wash with a dull, gray rock on W. side and a brown material forming its E. sides. Keep to right slope going up wash and continue to highest point and station. A 45-minute pack.

Station mark: Standard tablet stamped "TRAIL 1949" set in bedrock.

Reference mark No. 1: Standard tablet stamped "1" set in bedrock 39.34 ft. from station mark in azimuth 276°16'.

Reference mark No. 2: Standard tablet stamped "2" set in bedrock, 25.41 ft. from station mark in azimuth 345°21'.

V.A. elevation 2389 ft.

Latitude: 36°19'21.824" Longitude: 116°58'14.397"

To Station	Azimuth	Back Azimuth	Feet
Furnace Creek	213°15'39.8"	33°19'34.0"	58,807.6
Borax	252 19 20.6	72 26 12.2	59,617.8
Artists	267 46 39.5	87 51 31.8	40,411.0
Badwater	290 05 20.3	110 10 40.6	47,172.1
C&GS E.M.W. 680 1943"	332 28 15.7	152 31 45.4	62,937.7
Bennett	350 21 21.8	170 22 44.3	68,359.1

250 K1170



UNIT 7



FURNACE CREEK

Lat. 36°15'
Long. 116°45'

CALIFORNIA 324

CGCS 36 116 3

**Nevada 47
346**

(1)	L.F. Biggs	1907	A 6668
(2)	" "	" "	" "
(3)	G.W. Moore	1937	B 7246
(4)	" "	" "	" "
(5)	J.O. Durbin	1950	PV 82

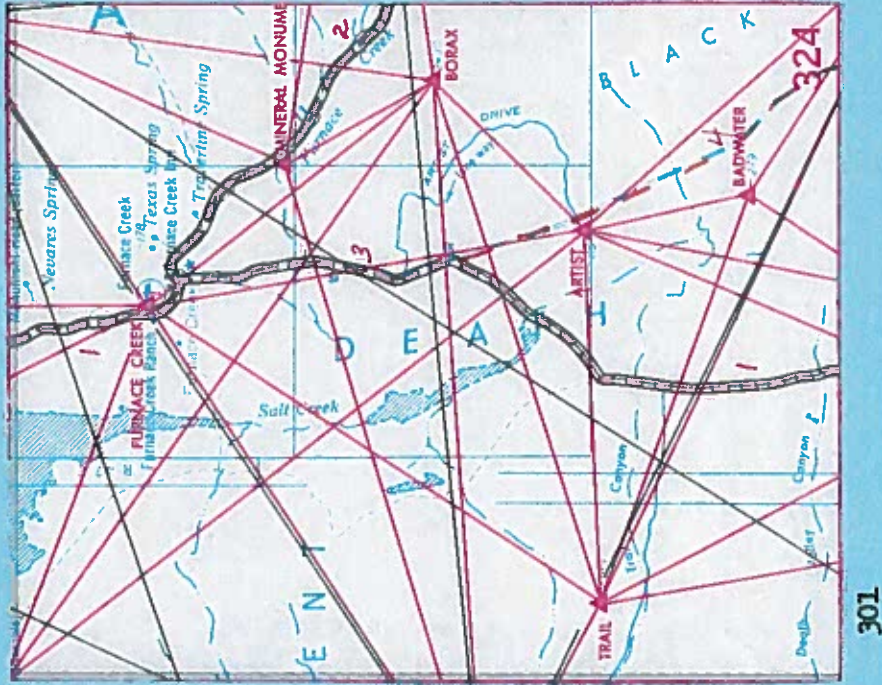

FURNACE CREEK (324)

California

L.F. Biggs, 1907

Third Order

Adjusted Elevations Based
On Sea Level Datum of 1929

Book: A 6668

Latitude 36°15' Longitude 116°45'

FILE COPY

- (1) FROM BENNETT'S WELL QUADRANGLE (301) NORTH THROUGH DEATH VALLEY
TO STATE LINE NEAR DAYLIGHT SPRINGS THENCE INTO CHLORIDE CLIFF
QUADRANGLE (346)

Bennett's Well, 7 mi N. of; 20 ft E. of rd.; iron post stamped
"B 1907 -253" (Not recovered) *-244.853

Bennett's Well, 10.1 mi N. of, 20 ft E. of rd.; iron post
stamped "B 1907 -263" (Not recovered) -254.351

Furnace Creek Ranch, 8.6 mi S. of; 20 ft E. of rd., in borax
flat; iron post stamped "B 1907 -284" Not Found '83 -275.133

Furnace Creek Ranch, 5.9 mi S. of; 20 ft E. of rd.; iron post
stamped "B 1907 -223" Not Found '83 -224.129

Furnace Creek Ranch, 2.8 mi S. of; 20 ft W. of rd.; iron post
stamped "B 1907 -227" OK '83 -218.558

Furnace Creek Ranch, at; 300 ft S. of house, at rd. fk.; iron
post stamped "B 1907 -178" (NOS Quad 36 116 3 Line 101) OK '83 -179.343
230 yards west of centerline of State Highway 190.
6 feet south of woven fence wire, in line with row of trees
directly behind registration office. (up-dated description from
NGS text)

*=Elevations having the minus sign are below sea level.

2/10/55

Retyped 4/15/71 blm *sp*

FURNACE CREEK (324)

California

L.F. Biggs, 1907

Third Order

Adjusted Elevations Based
On Sea Level Datum of 1929

Book: A 6668

Latitude 36°15' Longitude 116°45'

FILE COPY

(2) FROM RYAN QUADRANGLE (323) WEST TO FURNACE CREEK RANCH

Note: This line was run by Third Order methods but closure was 0.583 ft high in a distance of 11.6 mi. This closure error has been prorated in the line.

Smith Tank, 2.1 mi W. of; 8.1 mi E. of Furnace Creek; 30 ft
S. of rd.; in boulder; aluminum tablet stamped "B 1907 1330"

Not Found '83
1329.761

Furnace Creek, 2.5 mi E. of; at spring (head of Furnace Creek),
40 ft N. of rd.; iron post stamped "B 1907 283"

Not Found '83
282.300

2/10/55

Retyped 4/15/71 blm *af*

FURNACE CREEK (324)

California

G.W. Moore, 1937

Third Order

Adjusted Elevations Based
On Sea Level Datum of 1929

Book: B 7246

Latitude 36°15' Longitude 116°45'

FILE COPY

- (3) FROM POINT 2.8 MILES SOUTH OF FURNACE CREEK RANCH, SOUTH 3.1 MILES
ALONG OLD ROUTE TO OLD BENCH MARK "B 73 1907"

Furnace Creek Ranch, 2.8 mi S. of; 0.3 mi W. of hwy.; at Golden
Canyon Rd. fk.; 200 ft SE. of iron post "B 74 1907 -277",
40 ft W. of an old rd.; painted white, top of steel rod -217.48

Mushroom Rock, 1.6 mi N. of; at top of hill; 31 ft W. of rd.,
painted white, top of a steel rod -180.22

Mushroom Rock, 0.4 mi N. of; 4.9 mi S. of Furnace Creek Ranch;
40 ft W. of rd.; painted white, top of steel rod -231.46

Mushroom Rock, 0.6 mi S. of; 5.9 mi S. of Furnace Creek Ranch;
at top of hill; 100 ft S. of USGS iron post "-233 B 73 1907",
24 ft E. of rd.; painted white, top of steel rod -226.07

FURNACE CREEK (324)

California

G.W. Moore, 1937

Third Order

Adjusted Elevations Based
On Sea Level Datum of 1929

Book: B 7246

Latitude 36°15' Longitude 116°45'

FILE COPY

(4) FROM NEAR MUSHROOM ROCK SOUTHEAST ALONG ROAD TO BAD WATER

Furnace Creek Ranch, 6.8 mi S. of; 36 ft E. of rd.; set on conc. post; USDINPS tablet stamped "R.P.P.O.T. 571 + 02.95" ELEVATION -71.08" *OK-83* -71.092

Furnace Creek Ranch, 7.0 mi S. of; 55 ft NE. of intersection of hwy. SW. to Bennett's Well, 40 ft E. of hwy.; set on conc. post; standard tablet stamped "GWM 24 1937 71" (Not found, 1950) *Not Found '83* -70.963

Furnace Creek Ranch, 7.9 mi S. of; 46 ft E. of hwy.; set on conc. post; NPS tablet stamped "R.P.P.O.T. 515 + 62.62" ELEVATION -177.32 *OK-83* -177.314

Furnace Creek Ranch, 8.5 mi S. of; 53 ft E. of hwy., set on conc. post; NPS tablet stamped "R.P.P.O.T. 483 + 90.90" ELEVATION -203.81 *OK-83* -203.804

Furnace Creek Ranch, 9.4 mi S. of; at top of hill; 20 ft SW. of hwy.; set on conc. post; NPS tablet stamped "P I 439 + 17.48" ELEVATION -152.08 (Destroyed, 1950) *Not Found '83* -152.074

Furnace Creek Ranch, 9.6 mi S. of; at top of hill, opposite exit of one-way rd.; 40 ft SW. of hwy., set on conc. post; standard tablet stamped "GWM 25 1937 -163" *OK-83* -162.851

Furnace Creek Ranch, 9.7 mi S. of; at highest point on hill; 30 ft NE. of hwy.; set on conc. post; NPS tablet stamped "R.P.P.O.T. 422 + 79.82" ELEVATION -159.76" *Not Found '83* -159.751

Furnace Creek Ranch, 10.1 mi S. of; near foot of hill; 35 ft NE. of hwy.; set on conc. post; NPS tablet stamped "-200.77 R.P.P.O.T. 399 + 88.59" *Not Found '83* -200.760

Furnace Creek Ranch, 10.7 mi S. of; 45 ft NE. of rd.; set on conc. post; NPS tablet stamped "R.P.P.O.T. 367 + 64.40 ELEV -173.00" *OK-83* -172.991

Furnace Creek Ranch, 11.2 mi S. of; at top of hill; 40 ft NE. of hwy.; set on conc. post; NPS tablet stamped "R.P.P.O.T. 348 + 38.83" ELEV -165.33" (Not found 1950) *Not Found '83* -165.320

FURNACE CREEK (324)

California

G.W. Moore, 1937

Third Order

Adjusted Elevations Based
On Sea Level Datum of 1929

FILE COPY

Book: B 7246

- (4) Furnace Creek Ranch, 12.0 mi S. of; 82 ft SE. of intersection of T-rd. SE. to Salt Pools, 24 ft NE. of hwy.; in boulder; standard tablet stamped "GWM 26 1937 197" (Not found 1950) *Destroyed '83* -196.610
- Furnace Creek Ranch, 12.1 mi SE. of; 460 ft SE. of Salt Pools Rd. fk., 45 ft NE. of hwy.; set on conc. post; NPS tablet stamped "R.P.P.O.T. 295 + 35.05 -194.96" (Not found 1950) *Not Found '83* -194.934
- Furnace Creek Ranch, 12.4 mi S. of; 44 ft NE. of hwy.; set on conc. post; NPS tablet stamped "R.P.P.O.T. 275 + 35.38 -225.89" *OK-'83* -225.865
- Furnace Creek Ranch, 13.0 mi S. of; at foot of hill; 50 ft NE. of hwy.; set on conc. post; NPS tablet stamped "R.P.P.O.T. 247 + 58.87 -256.90" *Not Found '83* -256.870
- Furnace Creek Ranch, 13.4 mi S. of; at top of hill; 44 ft NE. of hwy.; set on conc. post; NPS tablet stamped "R.P.P.O.T. 225 + 19.83 -202.10" *OK-'83* -202.076
- Furnace Creek Ranch, 14.0 mi S. of; at Natural Bridge Rd. fk. E.; 45 ft SW. of hwy.; set on conc. post; standard tablet stamped "GWM 27 1937 -241" (Reset by L.R. Curtis, 1954) *Not Found '83* -236.954
- Furnace Creek Ranch, 14.06 mi S. of, along Bad Water Rd. to the Natural Bridge Rd. fk.; 3.5 mi N. of Bad Water; 36 ft NE. of and 4 ft higher than center of rd., 23 ft E. of signpost; in conc. post; standard tablet stamped "1 LC 1954 237" *OK-'83* -236.954
- Reference mark, 100 ft SE. of tablet; 48 ft SW. of hwy., painted white, steel rod -243.232
- Furnace Creek Ranch, 14.6 mi S. of; 40 ft NE. of hwy.; set on conc. post; NPS tablet stamped "R.P.P.O.T. 158 + 41.08 -248.28" *OK-'83* -248.280
- Furnace Creek Ranch, 15.4 mi S. of; at top of hill; 40 ft E. of hwy.; in conc. post; NPS tablet stamped "R.P.P.O.T. 119 + 6250 ELEV -209.50" *OK-'83* -209.471
- Furnace Creek Ranch, 15.7 mi S. of; on small rise, at foot of hill; 30 ft E. of hwy.; set on conc. post; standard tablet stamped "GWM 28 1937 256" (Not found 1950) *Not Found '83* -256.378
- Reference mark, 92 ft S. of tablet; 26 ft E. of rd.; painted white, top of steel rod -257.37

FURNACE CREEK (324)

California

J.C. Durbin, 1950

Third Order

Adjusted Elevations Based
On Sea Level Datum of 1929

Book: PV 82

Latitude 36°15' Longitude 116°45'

FILE COPY

(5) DOUBLE RUN SPUR LINE TO USGS TRIANGULATION STATION ARTIST 1949

Mushroom Rock, USGS standard tablet stamped "GWM 25 113 1937" -162.851

ARTIST TRIANGULATION STATION (USGS):

Latitude 36°19'37.037" Longitude 116°50'00.936" (Adj. 1955) - 85.009 Adj.

Reference mark No. 1 - 87.231 "

Reference mark No. 2 - 87.493 "

8/26/55

Retyped 4/15/71 blm *SP*

REPORT ON CONDITION OF SURVEY MARK

QUADRANGLE REPORT

STATE California COUNTY Inyo QUAD NAME Furnace Creek SW
 STATION NAME and/or NUMBER B 1907 -284 QUAD NUMBER 3611633 (324)
 LATITUDE _____ " TYPE of MARK: BM TRAV. TRIANG. DOPPLER
 LONGITUDE _____ " YEAR ESTABLISHED 1907 Line #1
 ELEVATION -275.133 ft/meter By USGS NGS OTHER _____ (Name of agency)
 CONDITION SFNF MARK STAMPED _____

REMARKS or REVISED DESCRIPTION: Due to vague description Bench Mark was not found.

SUBMITTED BY Ralph B. Findlay AGENCY U.S. Geological Survey DATE 04/28/83

Marks found in good condition need not be reported unless description is inadequate. Please prepare in triplicate. CSC-178

REPORT ON PERMANENT SURVEY MARK

AREA OFFICE

STATE California COUNTY Inyo QUADRANGLE Furnace Creek 324
 QUOTE PRIMARY REFERENCE Furnace Creek Ranch, 5.9 mi. S.
 (Direction and distance) Line 1
 DESIGNATION { LISTED B 1907 -223
 STAMPED B 1907 -223 TYPE OF MARK: BM TT _____ TRIANG. _____

Lat. _____ " CONDITION Disturbed
 Long. _____ " Destroyed USGS USBR
 Elev. -224.129 feet Not Found USC&GS State GS
 USNPS USNFS
 USGLO (Other)
 USBLM

REMARKS OR REVISED DESCRIPTION: A thorough search was made in the area of the mark. The site is at the edge of the salt pan and all other marks at this elevation which were found were destroyed. I presume this mark has also been eaten off at the ground and been destroyed.

Please prepare in triplicate.

SUBMITTED BY Thomas T. Smith DATE May 1, 1983
 TITLE Cartographer
 AGENCY US Geological Survey

Marks found in good condition need not be reported.

REPORT ON PERMANENT SURVEY MARK

AREA OFFICE

STATE California COUNTY Inyo QUADRANGLE Furnace Creek 324
QUOTE PRIMARY REFERENCE Smith tank, 2.1 mi. n. of;
(Direction and distance)

DESIGNATION { LISTED B 1907 1330 TYPE OF MARK: BM X TT _____ TRIANG. _____
STAMPED B 1907 1330

Lat. _____' _____" CONDITION Disturbed
Long. _____' _____" Destroyed ESTABLISHED BY USGS USBR
Elev. 1329.761 feet Not Found USC&GS State GS
USNPS USNFS
USGLO (Other)
USBLM

REMARKS OR REVISED DESCRIPTION: The road has been changed. A through search was made at the site of the mark and nothing was found.

Please prepare in triplicate.

SUBMITTED BY Thomas W. Smith
TITLE Cartographer
AGENCY US Geological Survey

DATE May 1, 1983

Marks found in good condition need not be reported.

FILL IN ALL AVAILABLE INFORMATION

REPORT ON PERMANENT SURVEY MARK

AREA OFFICE

STATE California COUNTY Inyo QUADRANGLE Furnace Creek 324
QUOTE PRIMARY REFERENCE Furnace Creek, 2.5 mi. E. of;
(Direction and distance)

DESIGNATION { LISTED B 1907 283 TYPE OF MARK: BM X TT _____ TRIANG. _____
STAMPED B 1907 283

Lat. _____' _____" CONDITION Disturbed
Long. _____' _____" Destroyed ESTABLISHED BY USGS USBR
Elev. 282.505 feet Not Found USC&GS State GS
USNPS USNFS
USGLO (Other)
USBLM

REMARKS OR REVISED DESCRIPTION: A through search was made in the area of the mark and nothing was found.

Please prepare in triplicate.

SUBMITTED BY Thomas T. Smith
TITLE Cartographer
AGENCY US Geological Survey

DATE May 1, 1983

Marks found in good condition need not be reported.

FILL IN ALL AVAILABLE INFORMATION