

4-24-12
LM

210107
AEKOLIT

Fayette

PUT 5



MW
Δ
14781

82

X 83

X 84

1850E

X 14785

Tail

PUT 62

2250E

Private Drive

MW
Δ
14787

1750M

Short

X 14791

X 93

X 89

X 88

14792

CK 14787

14786

CK 14781

Photos: 132-2695 Road

2696 Tail

Photos: 132-2697 Road

2698 Short

4-24-12
LW

210107
AEL10107
Fayette

16/9

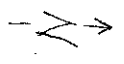

100-63

94

1500N

95 MW
96 Δ 14793

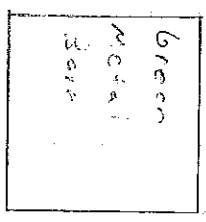

14797

14792

at 14793

Photos 133-2699 Road
2700 Bldg

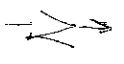

PUT 64

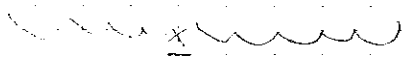

X14803

X102

MW
Δ 14799

2000E

X800

1500N

14804

at 14799

Photos 133-270 Road
2702 Trees

4-24-12
LM

210107
AERD/DT

Fo/12-10

Part 65

N

1225 N

MN
Δ
14805

X07

X03

X1200

185

Photos: 22-2703 Road

2704

14810

ck

805

N

1100 N

MN
Δ
14811

X12

X13

X14

X14815

S600+

Part 65

16/10

Photos: 22-2705 Road

2705 East

14816

ck 14811

4-24-12
LM

210107
AERO/D7
Fog/15-0

Part 65

N

1225 N

AKW
Δ
14805

X07

X02

185

X1200

14810

AK

805

Position:

32-2703 Road

2704

N

Part 65

1100 N

AKW
Δ
14811

X12

X13

X14

X14815

Slot

14816

AK 14811

Position: 32-2705 Road

2705 Slot

16/10

4-24-12
LM

210107
AERO/07
Fayette

PNT 67

N

1100N

X 18

X 19

X 20

600
Δ

14817

X 14821

Tail

14822 CK 14817

Photos: 112-2707 Road
2708 Tail

2200E

16/11

PNT 68

N

Bridge

X 24

X 25

X 26

Bridge

X 14827

NW
Δ

14823

2250E

14828 CK 14823

Photos: 111-2709 Road
2710 E. end

4-25-12

6:00

200' Survey

210107

14823

14823

14823

N

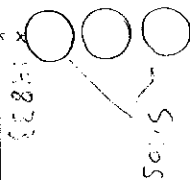

1075.00

X 32

X 31

X 30

MW Δ

14824

CF 14823

2711 Road
2712 E.L.C.

16/12

PUT 70

N

X 36

X 37

X 38

X 14839

Tail

MW Δ
14835

E 0582

14840

CF 14835

2712 Road
2711 E.L.C.

4-25-12

200 June

210107

6220/100
100 June

N

Power

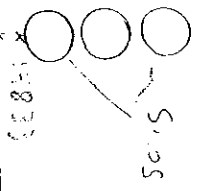

1075 M

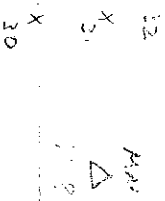

14834

CF 14834

2711 Road
2712 E46m

N

PUT 70

36

x 37

38

x 14839
T 1411

MM
14835

2850E

14843

CF 14835

2711 Road
2712 E46m

16/12

4-25-12
LM

210107
AERO/DT
F-104C

N ↑

900N

42 x

43

44

MND

Δ 14841

2900

x 14845

Trees

PUT 71

N ↑

900N

48

49

MND Δ 14847

x 50

x 14851

Shops

PUT 72

14846

CK 14846

14853

CK 14853

Plots: 132-2715 Road
2716 Trees

Plots: 132-2717, 2718 Road
2716 Trees

16/13

4-25-12
LM

210107
AER0107

Forest

PUT 71

N

900N

42 x

43 x

44 x

MND

Δ

14841

2900

X14825

Trees

N

900N

PUT 72

48

MND

Δ

14847

49 x

50 x

X14851

Snags

14853

CK CL618

Forest 142-27, 7 Road

14846

CK 14251

Photos 142-2715 Road

2716 Trees

16/13

4-25-12
LM

210107
AERO/D7
Fogate

PO-73

N

750N

600
Δ
14854

X
55
X
56
X
57

X 14858
Tall

14859

OK 14854

Photos: 132-2719 Road
2720 T₁₀

16/14

PO-74

N

700N

600
Δ
14860

X
52
X
53

X 14864
Brush

2800E

14865

OK 14860

Photos: 132-2722 Road
2722 Ground

4-25-12
EM

219107
M580129
F-1000

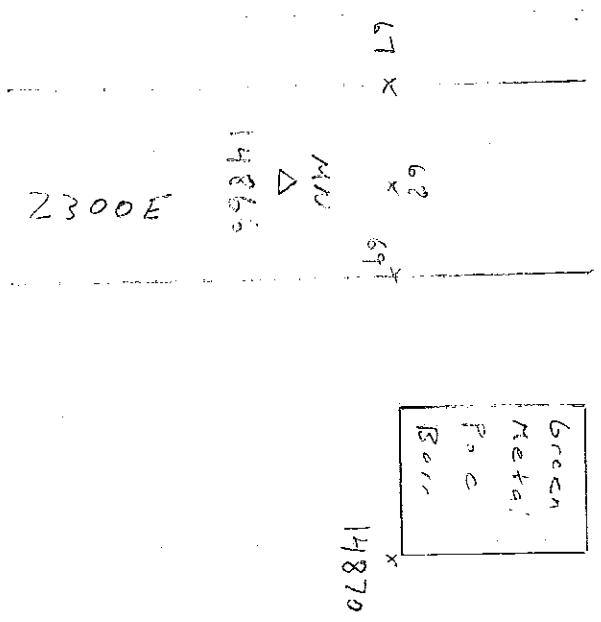

14871

CE 4866

Photos: 132-2723 Road
2724 ELDs

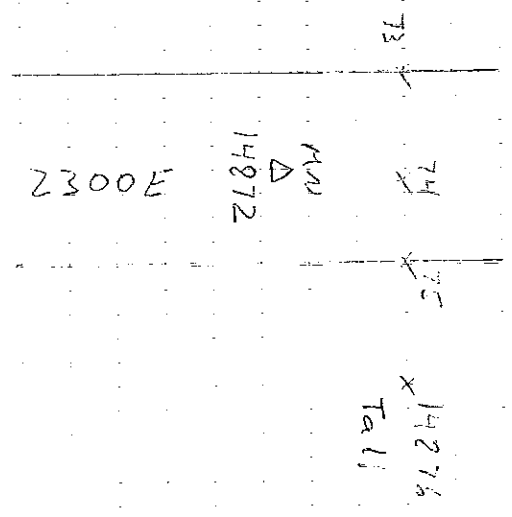
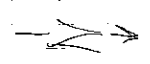

14877

CR 14872

Photos: 26-2725 Road
2726 Tall

PWT 76

16/15

4
4-25-12
LM

210107
AER0107
Eggs etc

N

900N

79 x

MW
Δ 14878

1900E

80 x 8

14882
Trees

PUT 77

14883

← 14872

Photos: 132-2727 Road
2728 Trees

16/16

700N

N

PUT 78

MW
Δ 14884

14884

x 85

x 86

x 87

x 14882

Bush

14889

CK 14884

Photos: 132-2729 Road
2730 Bush

4-25-12
LM

210107
AERO107
Fayette

16/17

A
N

PNT 79

X 91

800 N

X 92 MN
X 93 Δ 14896

* 14894
Brush

14895 CK 14890
14896 CK 14617

Photos: 32-2731 Road
2732 Brush

N

PNT 80

1700 E

X 900 MN
X 99 Δ 14897

Trees
X 901

14902 CK 14897

Photos: 32-2733 Road
2734 Trees

1150 N

X 98

4-25-12
LM

210107
AERO107
Fayette

PUT 81

N

04

MU

XOS

1050N

Δ

X_{OS}

14903

X14907

short

14908

CK 14903

Photos: 132-2785 Road
2736 short

16/12

PUT 82

N

MU

Δ

14909

10

X

X11

X12

X14913

1300E

1100N

14914

CK 14909

Photos: 132-2737 Road
2738 Tall

4-25-12
LM

210107
AERO/07

Fayette

PNT 81

N ↑

1050N

MU
Δ
14903

X₀₄
X₀₅
X₀₆

X 14907

short

14908

CK 14903

Photos: 132-2735 Road
2736 short

16/18

PNT 82

N ↑

MU
Δ
14909

X₁₀

X₁₁

X₁₂

X 14913

1300E

1100N

14914

CK 14909

Photos: 132-2737 Road
2738 Tall

4-25-12
LM

210107
AERO/07

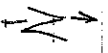

White
PWT 83

White Frame
RLOB
Immanuel
Lutheran Church

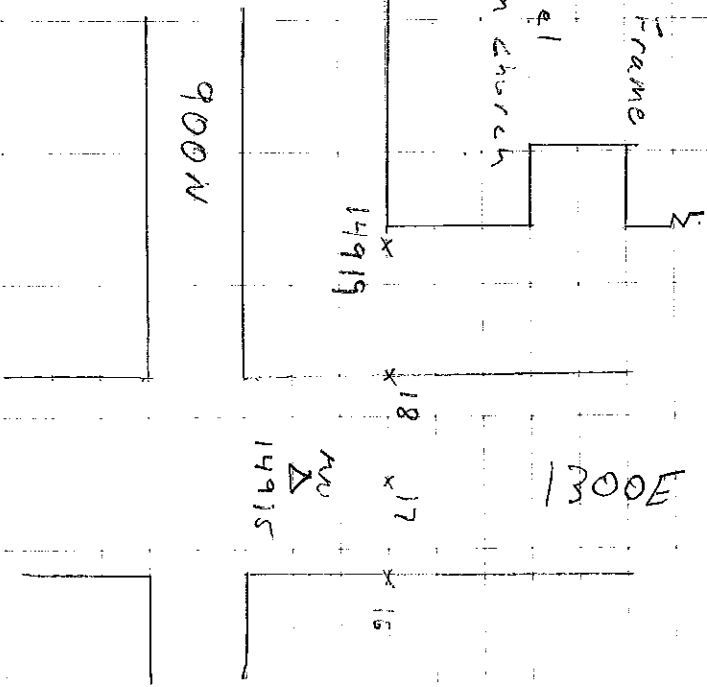

14920

CK 14915

Phase 1: 32-2739 Road
2740 BLD

16/19

PWT 84

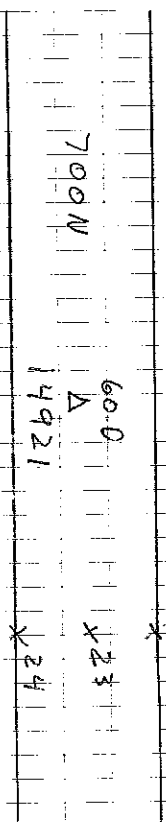

14926

CK 14921

Phase 1: 32-2741 Road

2742 BLD

4-25-12

210107

16/20

LM

AEROLOGY

Fayette

PWT 85

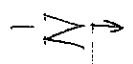

28 X 29 X 30

X 1493

SHORT

MW
Δ
14927

1100E

14932

CK 14927

Photos: 132-2743 Road
2744 Short

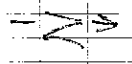

PWT 86

MW
Δ
14933

14937

BRUSH

X 36 X 35 X 34

1100E

14938

CK 14933

Photos: 132-2745 Road
2746 Brush

4-25-12
LM

210107
NE0107

Fayette

PN-87

N

X
42

1150N

HN
Δ
14939

X
40

14944

ck 14939

Photos: 132-2747 Road
2748 Tail

16/21

PN T 88

N

46

1125N

60 D
Δ
14945
47 X
48 X

14949



14950

ck 14945

Photos: 12-2744 Road
2750 BLDG

4-25-12
LM

210107

AERO/OT

Faye etc

PWT 89

↕
N

Trees
14955

CR 23
or
900W

MM
Δ
14951

x 54
x 53
x 52

14956 CK 14951

Photos: 132-2751 Road
2752 Trees

16/22

PWT 90

↕
N

x 58

750W

x 59
x 50
MM
Δ
14957

14961
x
a 11

14962 CK 14957

Photos: 132-2753 Road
2754 Fall

4-25-12
Ln

210107
AERODI
Favorite

PWT 91

MN
Δ
14963

64 x
65 x
66 x
14967
Brush

475 E

14968 CK 14963

Photo: 132-2755 Road
2756 Brush

N

PWT 92

100N
70 x
71 x
72 x

MN
Δ
14969

~~14973~~

Tree

14974 CK 14969

Photo: 132-2757 Road
2758

16/23

4-26-12
LM
900 Survey

210107
FERO/07
Fayette

14975 CK 2616

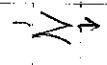

PWT 93

77 x 78
x 79
- 14980
x 5607

MW
Δ 14976
300N

300E

14981 CK 14975

Photos: 132-2759 Road
2760 Short

16/24

PWT 94

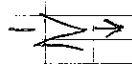

300N

x 84
x 25
MW
Δ 14982

x 14986
Tall

14987 CK 14982

Photos: 132-2761 Road
2762 Tall

4-26-12
LN

210107
AERO/DOT
Fayette

PUT 95

↑
N
↓

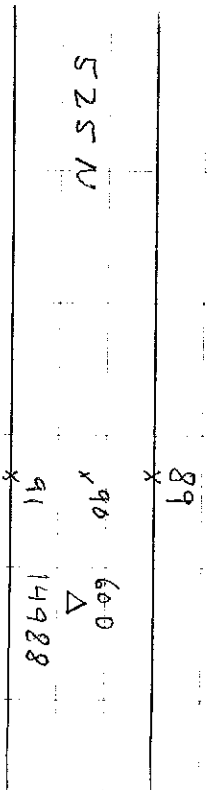

x
 14992
 x
 Conc. Block
 Frame
 Bar
 91

No check shot. MFI would not connect.

Front 2763 Road
2764 Bldg

16/25

PUT 96

↑
N
↓

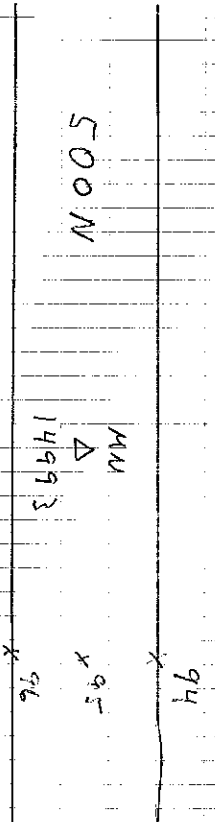

14998
 CK 14993
 95
 x 14997
 96

Photos 182-2765 Road
2766

4-26-12
Lm

Z10107
FERRIS

Fayette

PUT 97

↖ N ↗

17000

X

700 N

NW

Δ

14999

X 01

X 02

X 17003

7004

CK 14999

Photos 22-2767 Road
2768 Fall

16/26

PUT 98

↖ N ↗

X 06

700 N

17005

Δ

NW

X 07

X 08

X 17009

Trees

7010

CK 17005

Photos 132-2769
2770 Trees

4-26-12
LM

210107
AERO/D7
Fayette

PUT 99

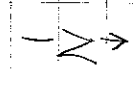

17015

Brush

X 14

X 13

X 12

17011

MU
Δ

405E

17016

CK 17511

Photos: 32-2771 Road
2772 Brush

16/27

PUT 100

White Frame
SLO6

Fittsburg
Church

17021

X 20

X 19

MU
Δ
17017

900N

X 18

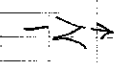

17022

CK 17617

Photos: 132-2773 Road
2774 BLS

4-26-12
LM

210107
AEROPLOT
Fayette

PLOT 101

N

Sloot
X 17027

X 26

X 25
MAD
Δ 17023

X 24

1100N

17028 CK 17023

Photost 32-2775 Road
2776 Sloot

16/28

PLOT 102

N

X 17033

Tail

X 32

X 31

X 30

MAD
Δ 17029

1150N

17034 CK 17029

Photost 32-2777 Road
2778 Tail

4-26-12
LM

210107
AERO107

Fayette

PAUT 103

N
N

1275 N

MW
Δ
17035

X 36
X 37
X 38

X 17039
short

17040 CK 17035

Photos: 132-2779 Road
2780 short

16/29

N
N

PAUT 104

17045

Tail

X 44
X 43
X 42

MW
Δ
17041

D.R. II

1525 N

17046 CK 17041

Photos: 132-2781 Road
2782 Tail

4-26-12
LM

210107
AERO/07

Fayette

PWT 105



X
48

1700N

X 49

MW
Δ

X 50

17047

X 17051

Brush

17052 CK 17047

Photos: 132-2783 Road

2784 Brush

16/30

PWT 106

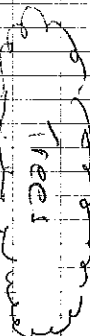
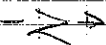

X 17057

X 56

X 55

MW
Δ

17053

X 54

17058 CK 17053

Photos: 132-2785 Road

2786 Trees

7-26-12
LM

210101
AER0107

Favorite

PWT 107

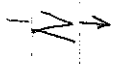

MW
Δ

17059

60 x

61 x

62 x

x 17063
Tail

100E

17064

CK 17059

Photos: 132-2787 Road
2788 Tail

16/31

PWT 108

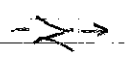

MW
Δ

17065

66 x

67 x

68 x

200E

17070

CK 17065

Photos: 132-2789 Road
2790 BLDG

White Metal
Pole Barn
w/ Green Roof

17069

4-22-12
4-26-12
km

210107
AER 2/07

202015

PUT 109

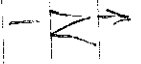

7075

x

Bush

x 74

x 73

x 72

MU

Δ 17071

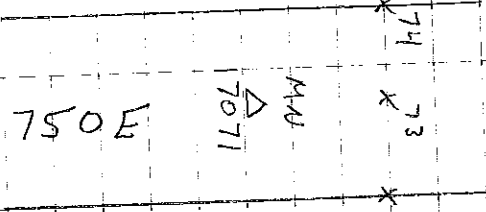

750E

17076

CK 17071

Photos: 22-2791 Road
2792 Bush

16/32

PUT 110

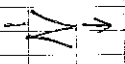

17077

MU

x 80

17081

x 79

x 78

Short

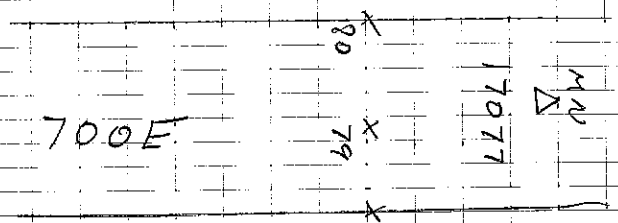

700E

17082

CK 17077

Photos: 22-2793 Road
2794 Short

4-26-1977

210197
Fogate

N

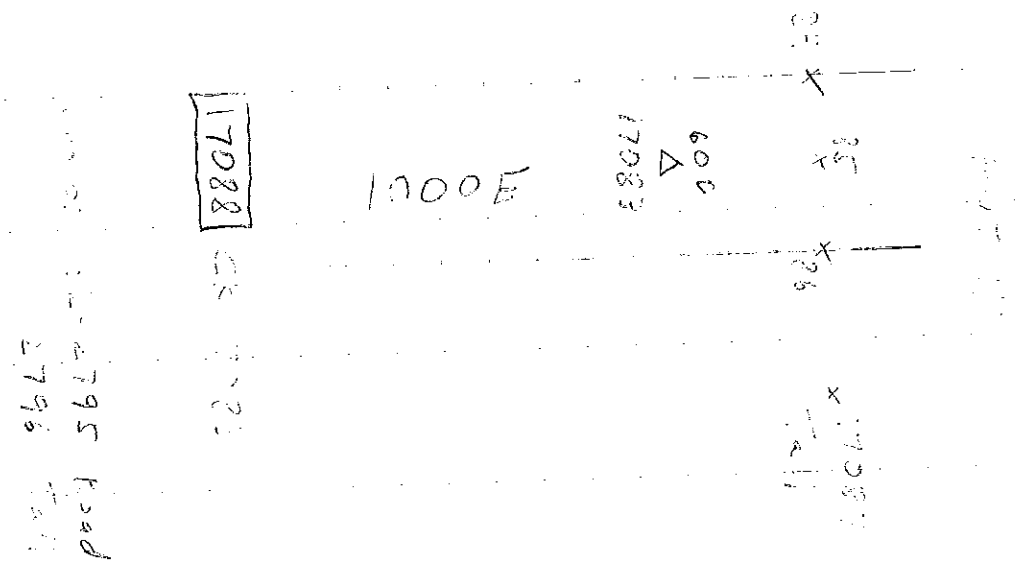

17088

ck 17083

PNT 112

Trees

X17093

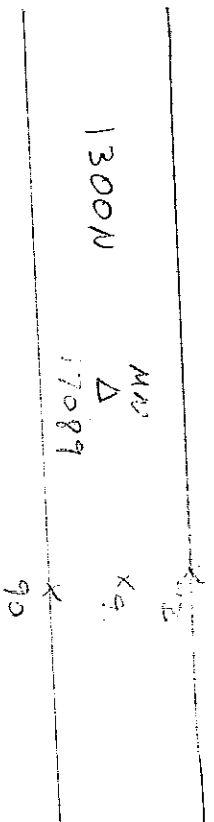

17094

ck 17089

P. 2795 2797 Road
2798 Trees

16/33

4-26-11
LM

210107
AERO107
Fayette

16/34

White Frame
R106
PWT 113

Overcup
Baptist
Church

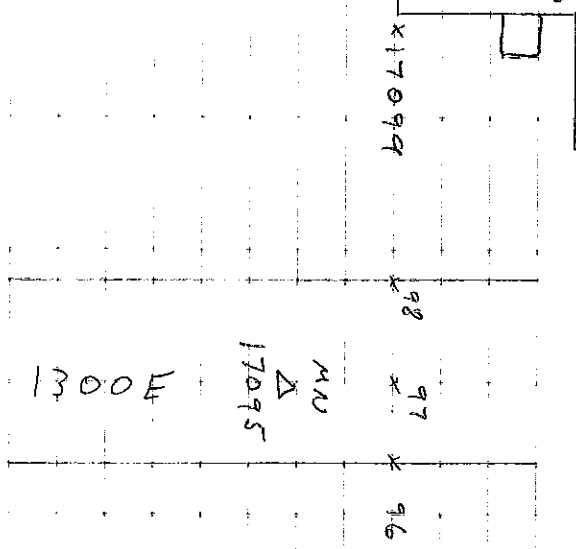

17100 CK 17095

Photos: 132-2799 Road
2800 R106

PWT 114

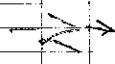

1275N

MM
17101

x17105

Bvd14

x04
x03

x02

17106 CK 17101

Photos: 32-2801 Road
2802 Bvd14

4-26-12

2003

N

PROT 115

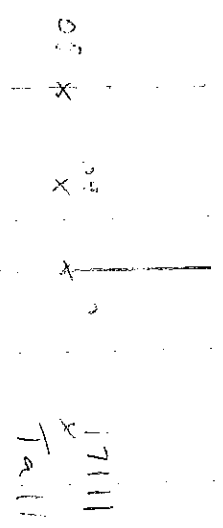

MW
Δ
17107

1575 E

17112 CK 17107

32-2803 Road
2804 Tall

16/35

N

PROT 116

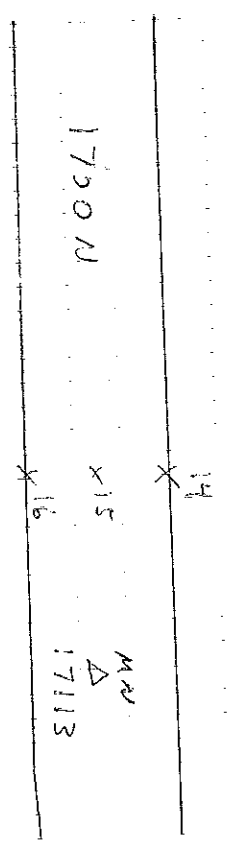

MW
Δ
17113

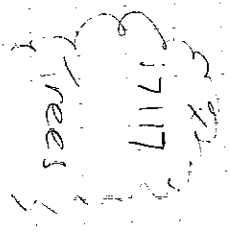

17118 CK 17113

Protos 132-2205 End
2206 Tall

4-27-12
LM
5:50 Sun

210107
K&P/07
F&S/07

N
↑

1700 N

MN
Δ
17119

x 21
x 22

x 20

185

White frames
BIDs
Temple Baptist
Church

17124
17125

CK 17119
CK 2613

Photos: 132-2807 Road
2808 RLD6

N
↑

1500 N

MN
Δ
17126

x 29
x 28
x 27

PUT 118

x 17130
x 17411

17131

CK 17126

Photos: 132-2808 Road
2810 TAD1

4-27-12
LM

210107
AERO/07

Fayette

PUT 119

N
N

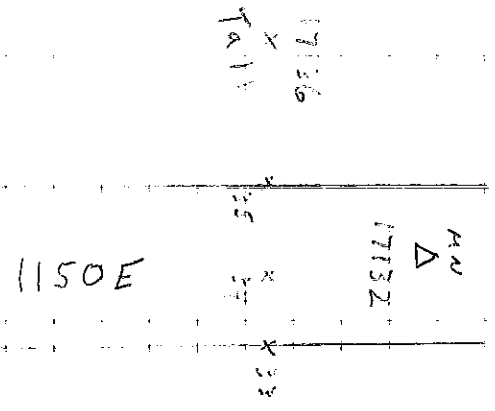

17137

CK 17132

Photos: 132-2811 Road
2812 Fall

16/37

PUT 120

N
N

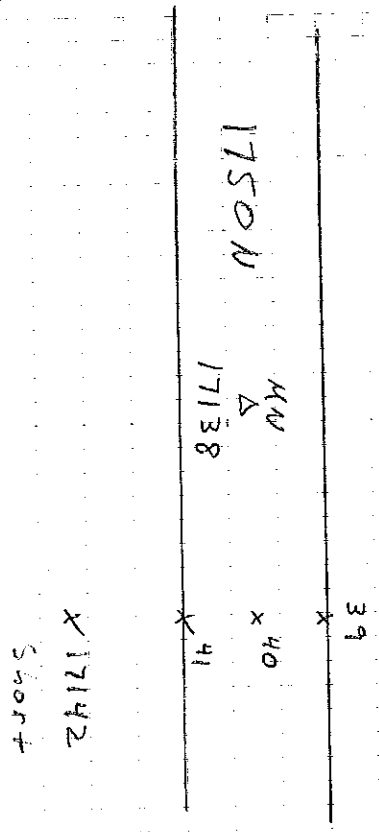

17143

CK 17138

Photos: 132-2813 Road
2814 Short

4-27-12
LM

210107
AERO/DI
Fayette

PWT 60

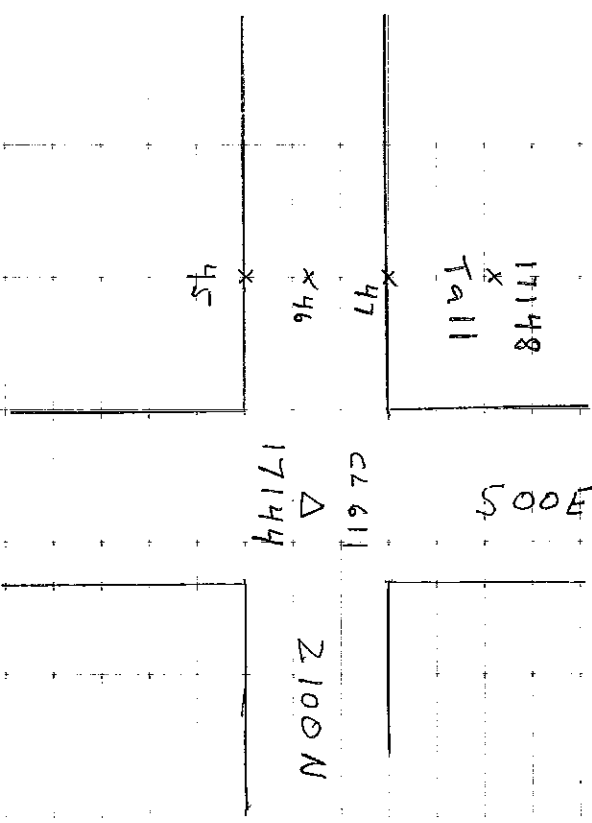
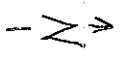

No check slot. No connection.

Photos: 132-2815 Good
2816 Tall

16/38

PWT 59

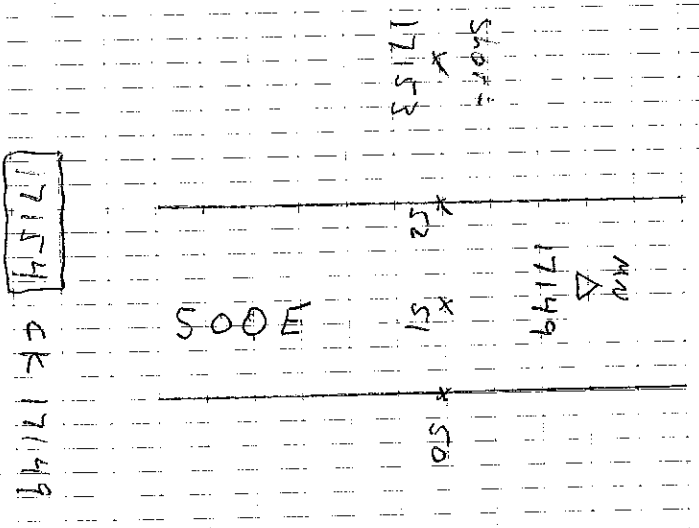
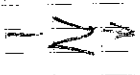

17154 CK 17149

Photos: 132-2817 Good
2818, 549

210107
AEG2/02
Begin TAYLOR

1 NAIL
ROAD 16074
- 16076
TALL 16077
CK 16078

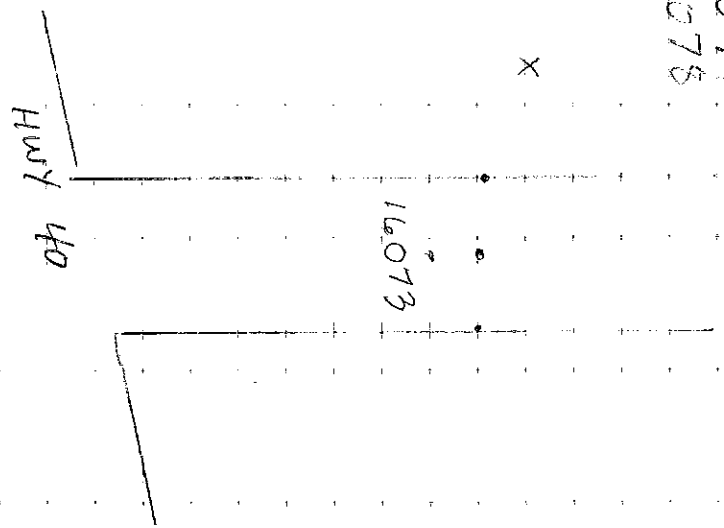

PIC 3633 ROAD
3634 TALL

4.2412 GPS B... MP

2 NAIL
ROAD 16080
- 16082
BRUSH 16083
CK 16084

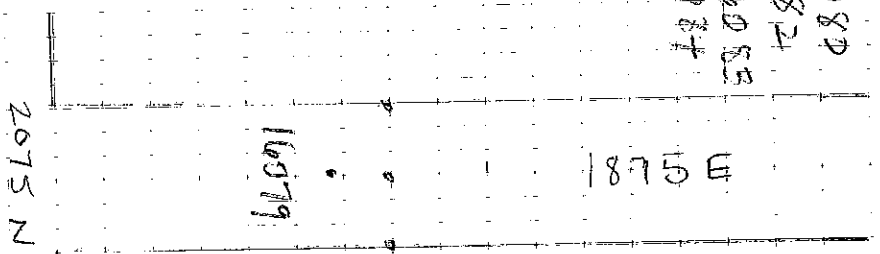

PICS 3635 ROAD
3637 BRUSH

210107

AEND / D7

3 NAIL
ROAD 16085
- 16087
BLDG 16082
CK 16089

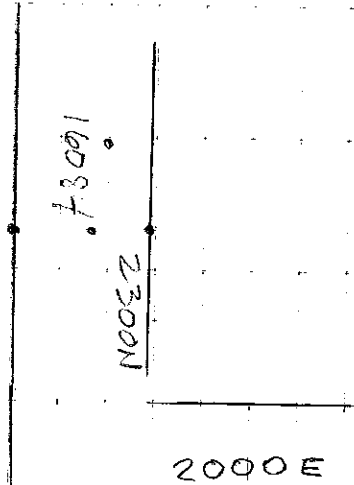

PICS
36038 ROAD
36039 BLDG

35/11

42412

SPS B1

MP

4 NAIL
ROAD 16094
- 16093
SHORT 16094
CK 16095

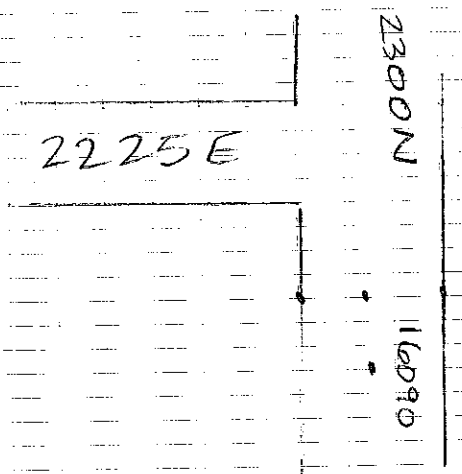

PICS
36412 ROAD
36413 SHORT

MISSING:
Moultrie Co.

210107
AERS/D7

5 MAIL
ROAD 16097
- 16099
TALL 16100
CR 16101

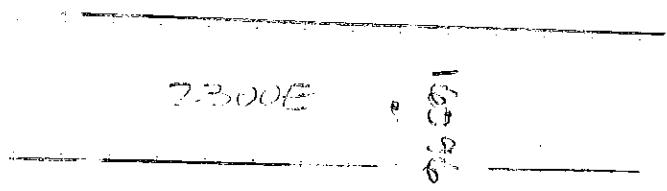

PICS 3644
3645
ROAD TALL

4.24.12
GPS B
MP 30/17

6 MAIL
ROAD 16103
- 16105
WOODS 16106
CR 16107

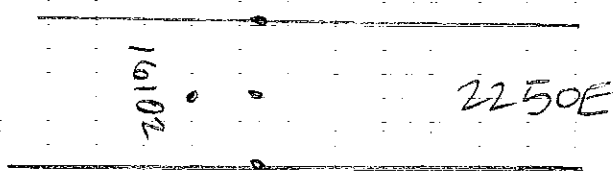

PICS 3646
3647
ROAD WOODS

WOODS

210107
AERO/D7

7 NALL
ROAD 16109
- 16111
WOODS 16112
CK 16113

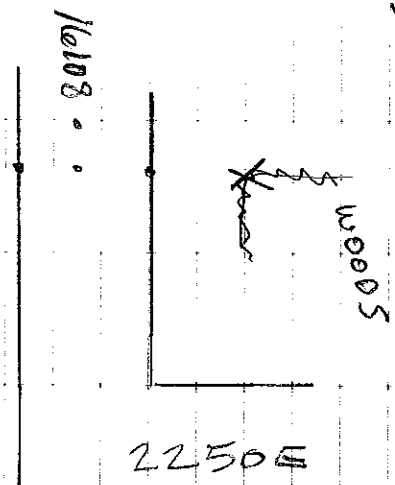

PICS
3648 ROAD
3649 WOODS

210107
AERO/D7 MP

42412
8 NALL
ROAD 16115
- 16117
TRAIL 16118
CK 16119 LAST

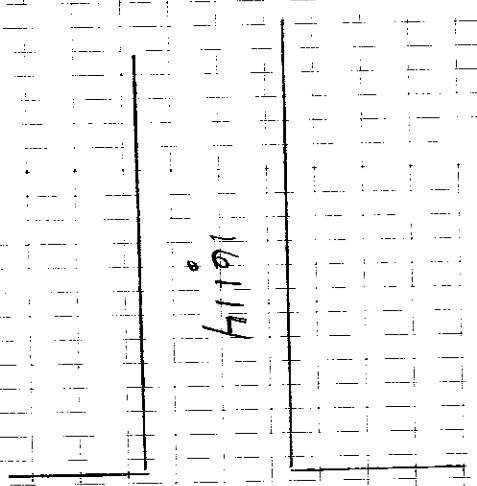

3650 ROAD
3651 TALL

210107

AERO 107
* FAYETTEE CONST. *

9 NAIL

ROAD 16121

-16123

BUSH 16124

CK 16125

2800N

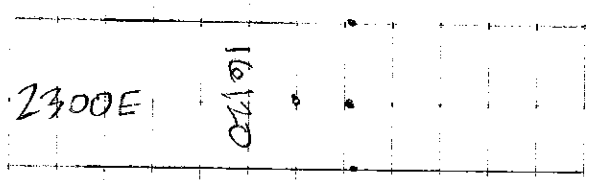

PIC

31652
31653

ROAD
BUSH

38/1

4.25.12
GPS E
70° pressure
A/D

10 NAIL

ROAD 16127

-16129

TALL 16130

CK 16131

2950N

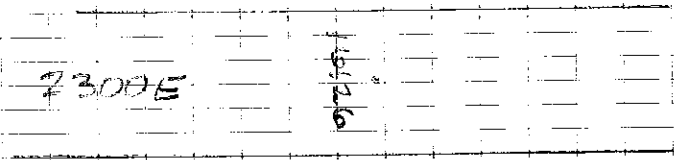

PIC

31654
31655

ROAD
TALL

Missing!
Moultrie Co.

210107
AERO 107

11 NAIL
ROAD 16133
16135
Bldg 16136
CK 16137

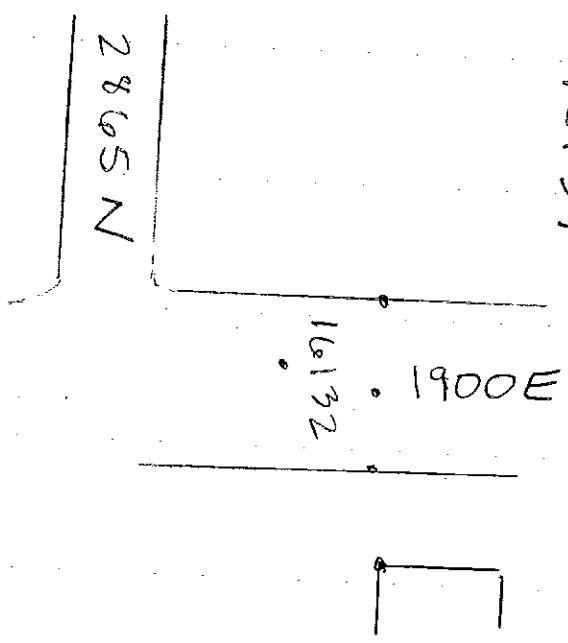

PIC 3656 ROAD
3657 BLDG

4.25.12 GPS B
MP 39/14

12 NAIL
ROAD 16139
16141
SHORT 16142
CK 16143

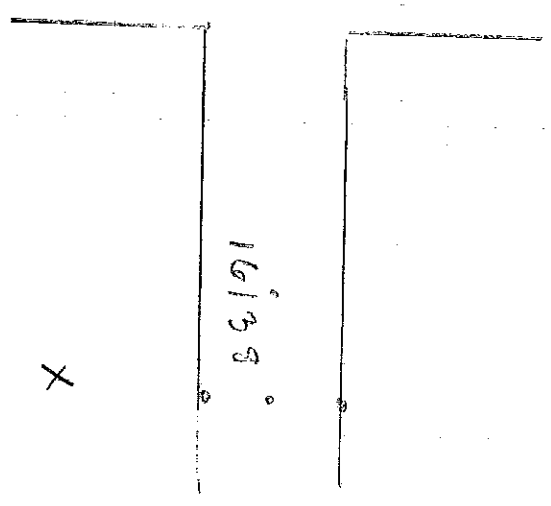

PIC 3658 ROAD
3659 SHORT

Missing!
Moultrie Co.

210107
AERO/D7

13 MAIL
ROAD 16145
- 16147
B206 16148
CK 16149

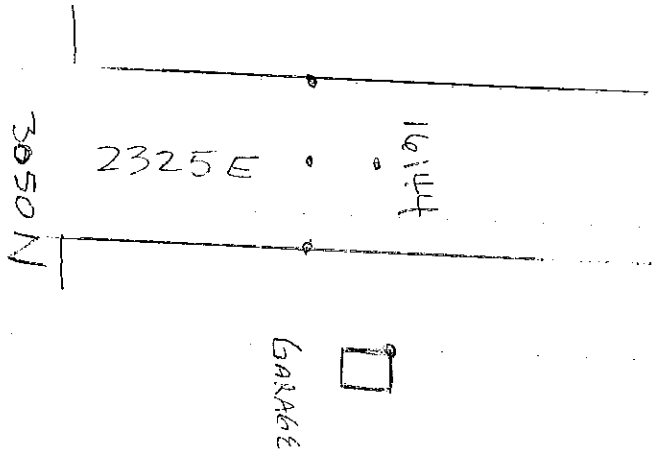

Pics 3460
3661
ROAD 6-06

42512 GPS 'B'
AIR 401/11

14 MAIL
ROAD 16151
- 16153
TALL 16154
CK 16155

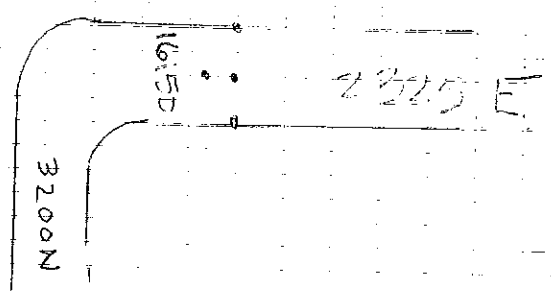

PIC 3662 ROAD
3663 TALL

210107
AERO/D7

15 MAIL
ROAD 10/57
- 10/59
TALL 10/60
OK 10/61

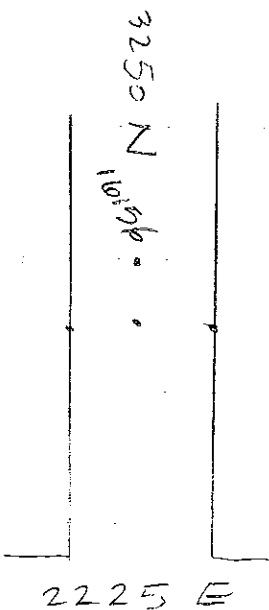

PICS
3664 ROAD
3665 TALL

4.25.12

GPSB'

4/11
NO 17

15 MAIL
ROAD 10/63
- 10/65
WOODS 10/66
OK 10/67

3100 N

PICS
3664 ROAD
3665 SHORT

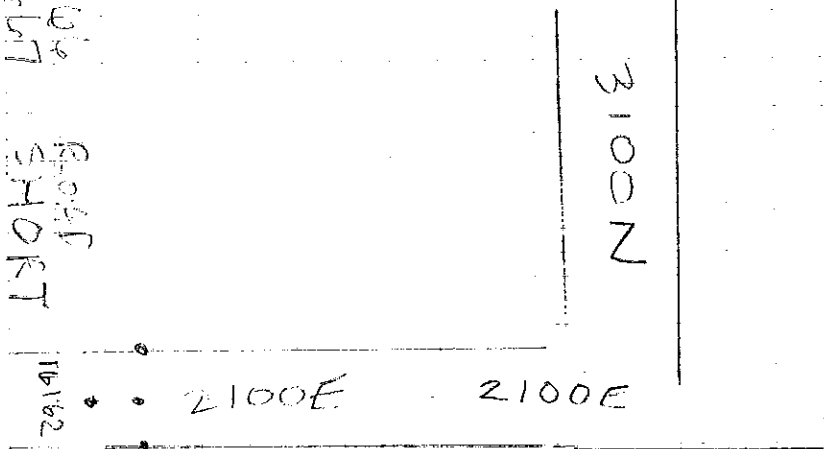

MOORE CO.

210107

FIELD 2-

4.25.12

GPS 4

MAP 17

42

17N
ROAD 16169
- 16171
WOODS 16172
CK 16173

WOODS

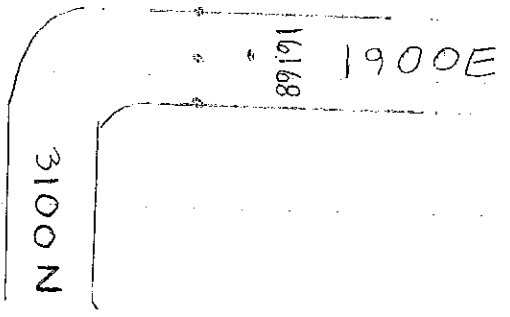
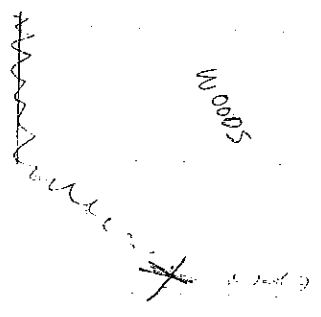

18N
ROAD 16175
- 16177
BRUSH 16178
CK 16179

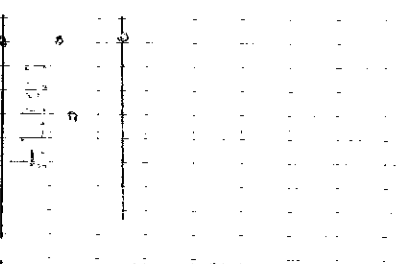

PICS
3663 ROAD
3669 WOODS

PICS
3670 ROAD
3671 BRUSH

MISSING!
Moultrie Co.

210107
SEEDS

17 NAIL

ROAD 16169
- 16171
WOODS 16172
CK 16173

WOODS

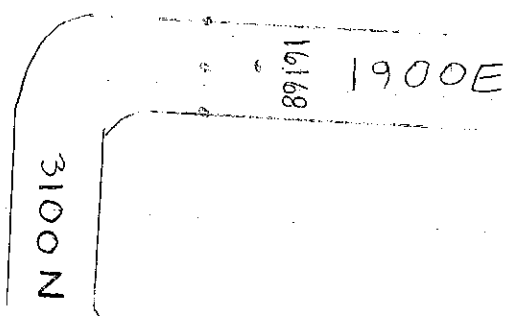
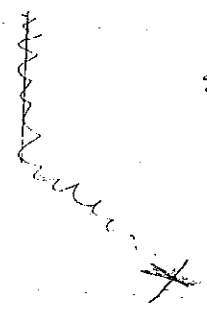

6.25.12

GPS

42
16174

18 NAIL
ROAD 16175
- 16177
BRUSH 16178
CK 16179

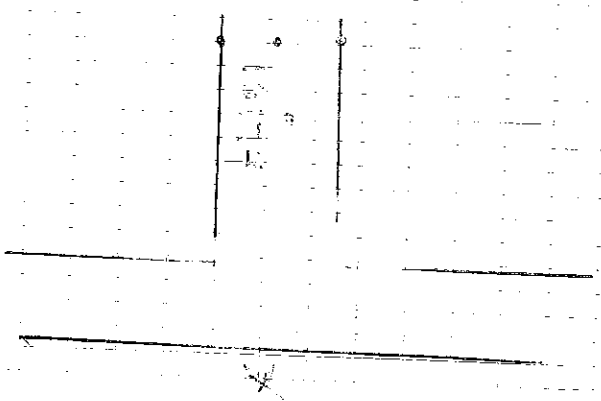

PICS
3668 ROAD
3669 WOODS

PICS
3670 BRUSH
3671 BRUSH

210107
HEAD/D7

19 NAIL
ROAD 16181
- 16183
BRUSH 16184
CK 16185

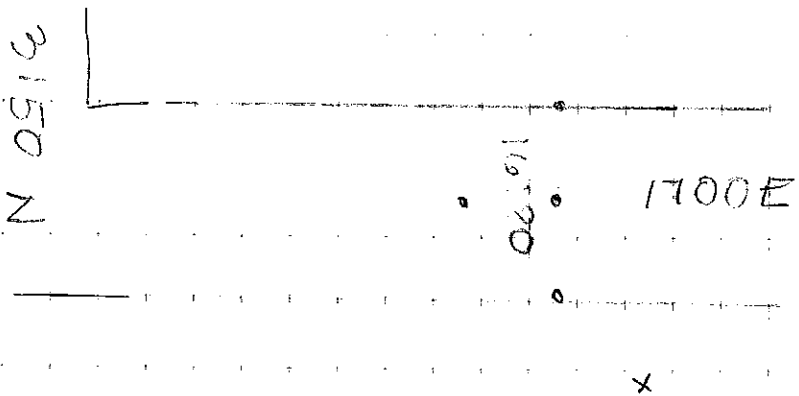

PICS 3672 ROAD
3673

4.25.12 GRS'B' MP 43
17

20 NAIL
ROAD 16187
- 16189
WOODS 16190
CK 16191

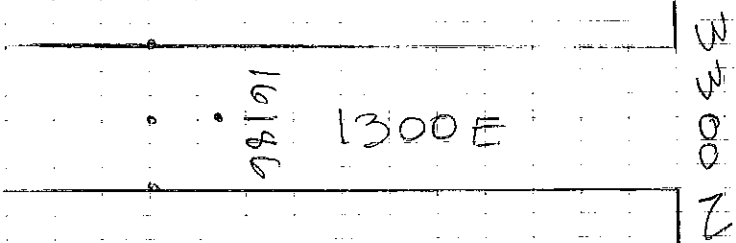

PICS 3674 ROAD
3675 WOODS

210101

4.25.12

GPS B

110

4 1/4

16103
- 16103
BLDG 16100
CK 16107

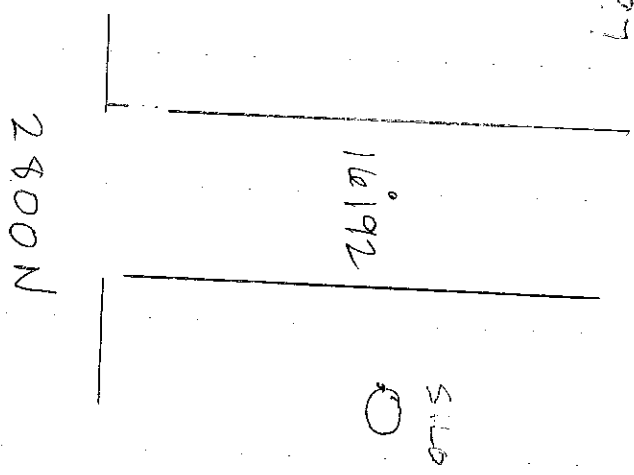

22 MAIL
ROAD 16199
- 16201
TAIL 16202
CK 16203

1200E

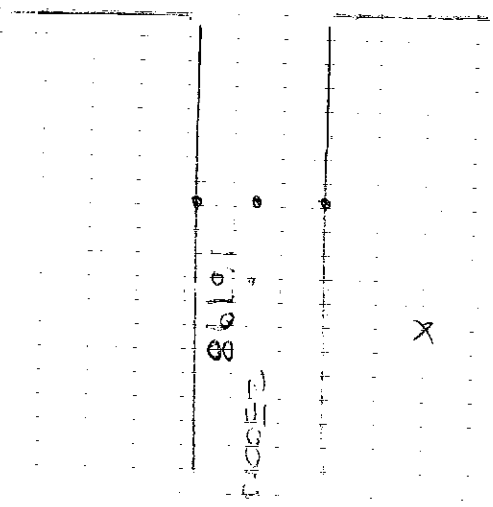

PICS
3674
ROAD
SILS

PICS
3677
3679
ROAD
SILS

210107
A3E00 / 210

23 NW 1/4
ROAD 16206
- 16208
TALL 16209
CK 16210

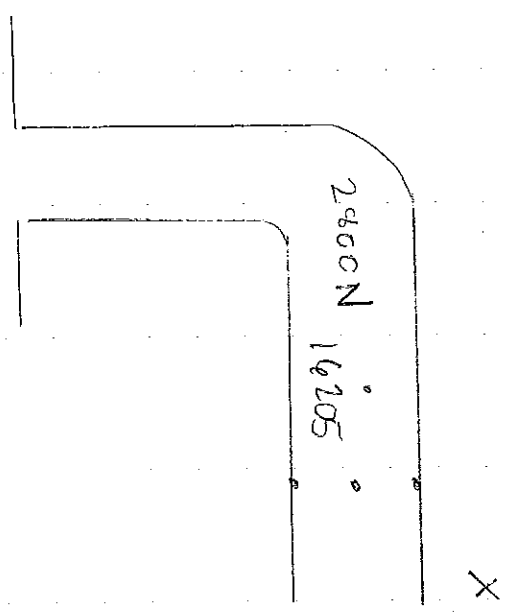

Pics
3640
3641
R07L
TALL

425.12

GPS B

16
map 11

24 NW 1/4
ROAD 15212
- 15214
SHORT 16215
CK 15210

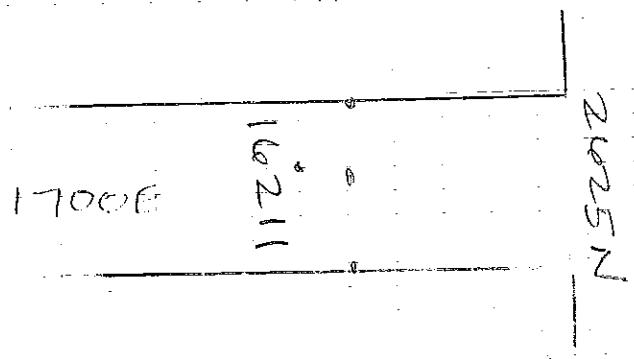

Pics
3642
3645
ROAD

Missing!
Moultrie Co.

210107
AERS / D7

4.25.12
GPS B
MP 46 / 11

25 NAIL
ROAD 16220
- 16223
TALL 16224
CK 16225

26 NAIL
ROAD 16227
- 16229
WOODS 16230
CK 16231

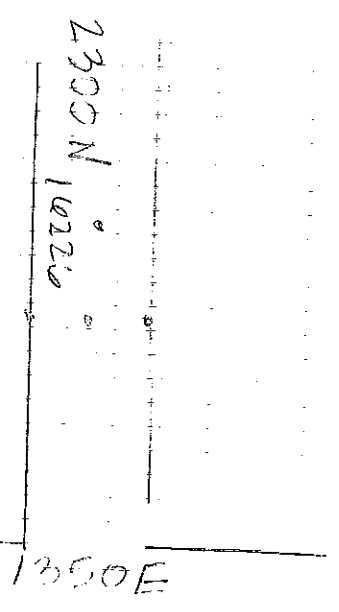
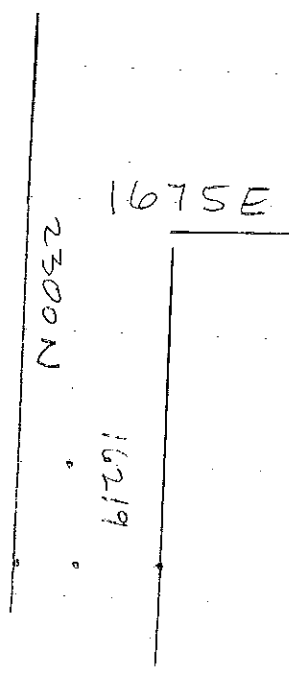

3684
3685
ROAD
TALL

3686
3687
ROAD
WOODS

Missing!
Moultrie Co

210107
AEC 10 / DT

4.25.12
GPS B
MP
47
/11

27 NAIL
ROAD 16233
-16235
FALL 16230
CK 16237

28 NAIL
ROAD 16239
-16241
SHORT 16242
CK 16243

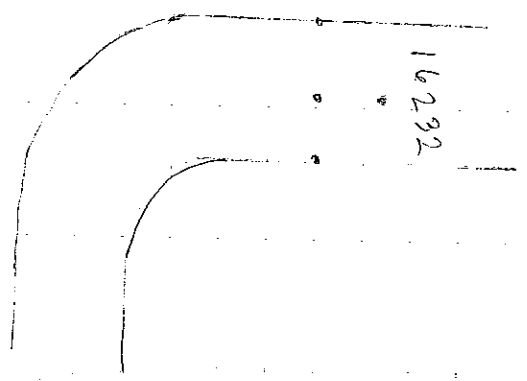

16231
1900 N

1375E

PICS
3656
3649
ROAD
FALL

PICS
3640
3641
ROAD
SHORT

Missing!
Moultrie Co

210.07
AERD 07

20 NAIL
ROMC 16245
- 16247
BLDG 16248
CK 16249

20000000

16247

PIES
33000
33000
ROMC
BLDG

425.12
GPS 6
07

30 NAIL
ROMC 16251
16252
BLDG 16254
CK 16255
16256

2100N 16250

1600E

PIES
33000
33000

48
17

X

Missing!
Moultrie Co

210107
* AEEED DOT
FAVETTES DIST... *

42602
SOS'B
105 14
40

31NAW
ROAD 10254
7-10255
CIR 10256

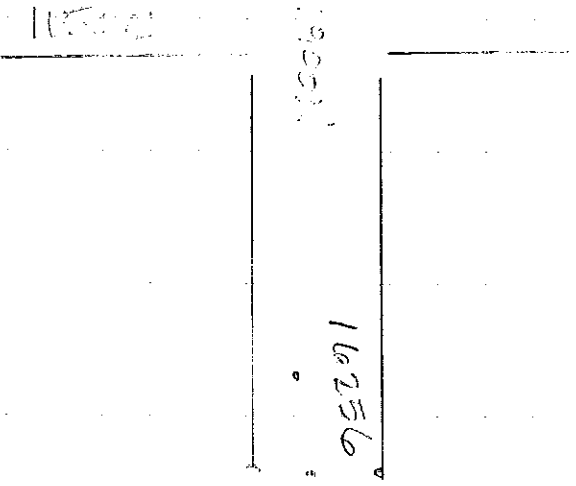

32NAW
ROAD 10263
- 10265
BUSH 10269
CIR 10267

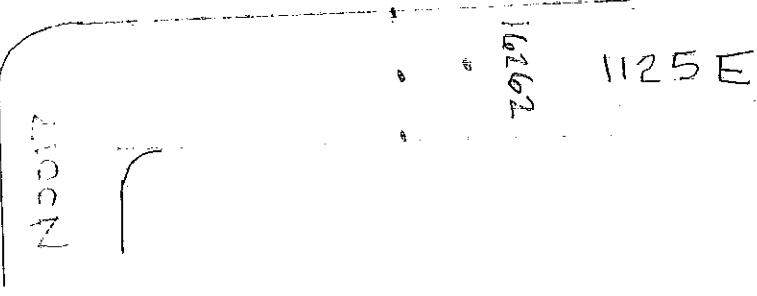

PICS
31096 ROAD
30977 TALL

PICS
30978 ROAD
30979 GRISH

Missing!
Moultrie Co.

210107

FERRO RD

33 NAIL

ROAD 16269

16271

TALL 16272

CK 16273

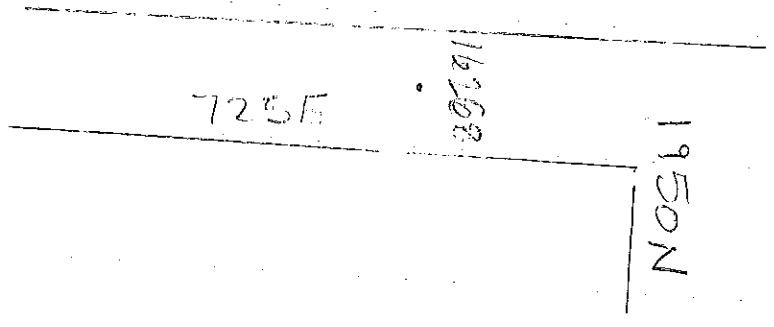

412412

GIS A

MP H

34 NAIL

ROAD 16275

16277

BLDG 16278

CK 16279

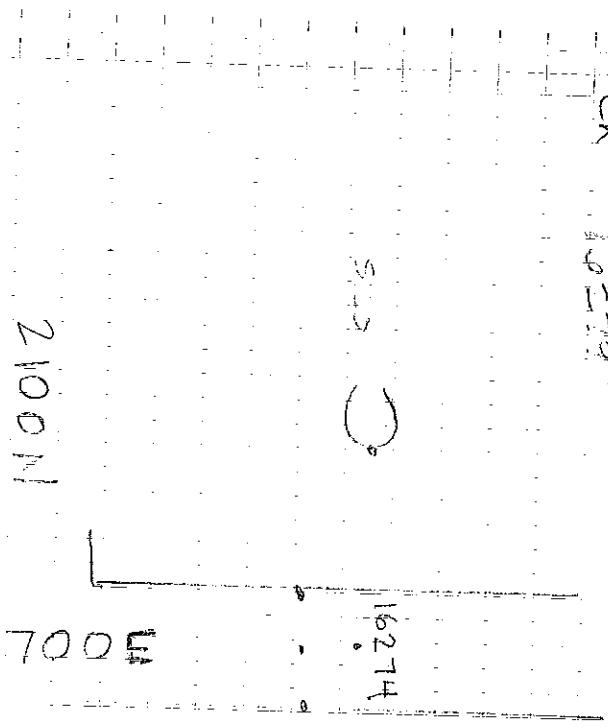

PICS 3700
3701 ROAD
TALL

PICS 3702
3703 ROAD
3704 TALL

50

210101
AERO/D-

35 NA
ROAD 16281
- 16283
SHORT 16284
CK 16285

2400N

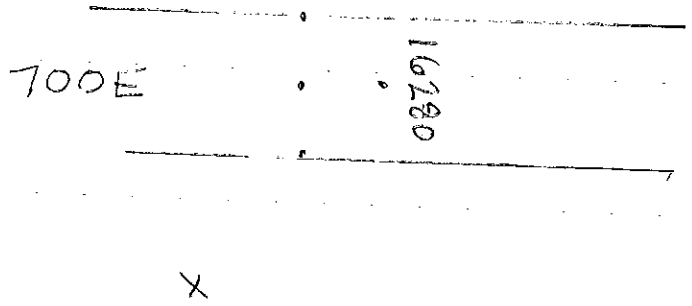

PIC9 3712 ROAD SHORT
3714

42012 GPSB M/11
5/1

36 NA
ROAD 16287
- 16289
TALL 16290
CK 16291

700E

2500N

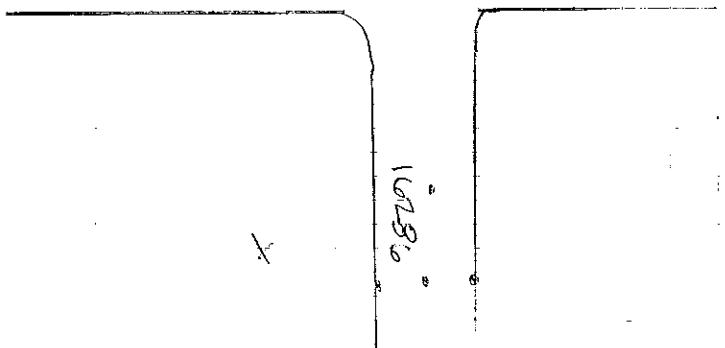

PIC5 3715 ROAD TALL
3717

210107
AERO/D7

37N44L
ROAD 16293
-16295
WOODS 16296
CR 16297

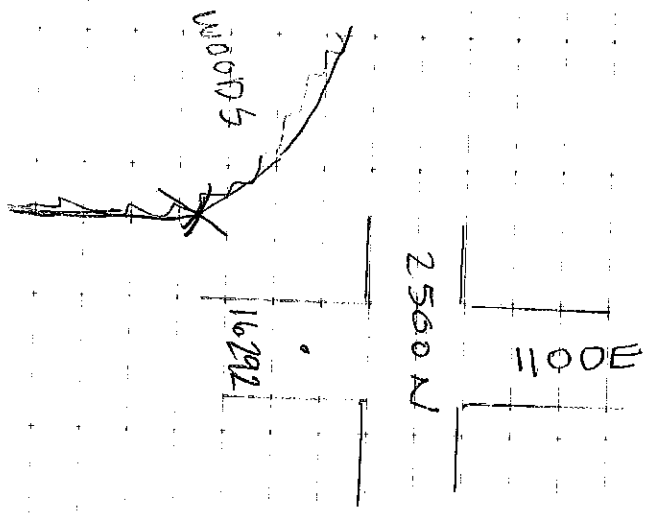

PICS 3718 ROAD
3719 WOODS

426.12

GPS B'
68' CLEAR

MP 17

38 N44L
ROAD
WOODS
CR

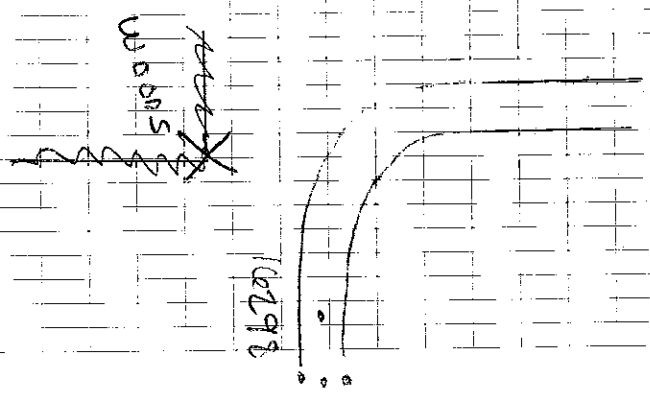

PICS 3720 ROAD
3721 WOODS

210107
AEROS B7

39 NAIL
ROAD 16305
- 16307
TALL 16308
CK 16309

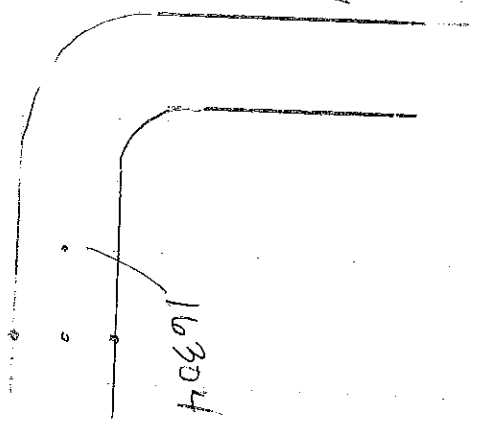

X

PICS 3722 ROAD
3723 TALL

4.26.02 GPS B MF

40 NAIL
ROAD 16311
- 16313
BLOG 16314
CK 16315

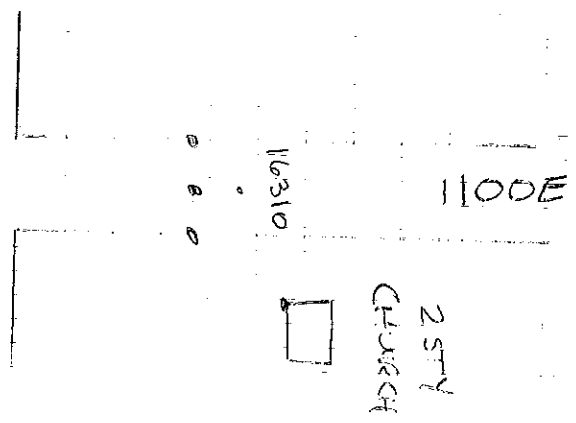

PICS 3724 ROAD
3725 BLOG

53/4

215 07
163127

41 NE
ROAD 16317
- 16319
BRUSH 16320
CX 16321

X

16316
3200N

PICS 3726
3727

ROAD
BRUSH

42612 GPS B

42 MAIL
ROAD 16323
- 16325
SHORT 16326
CX 16327

X

16322

PICS 3728
3729 ROAD
SHORT

54
APP-11

215 01
215 02

H1 NR
ROAD 16317
- 16319
Bicusid 16320
CX 16321

X

16316
3200N

PICS 3726 ROAD
3727 Bicusid

426 12 GIS B

H2 NR
ROAD 16323
- 16325
SHOR 16326
CX 16327

X

16322

PICS 3928 ROAD
3929 SHOR

54
AP 11

Missing!
Moultrie Co.

550 57
AEL 27/29

35 N.W. 76° 30
K.A. 10332
SHORT 10333
SR 10334

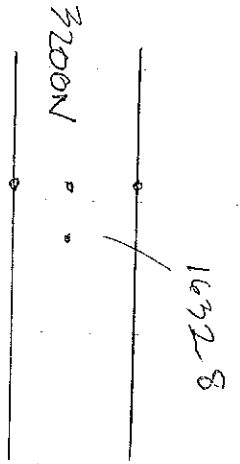

550 57

3730 ROAD
3731 SHORT

4126.12

Gps B 1

MP

55 1/4

44 NAIL
ROAD 16336
- 10338
TALL 10339
SR 10340

X

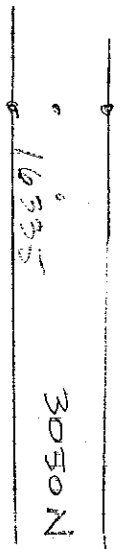

550 57

3732 ROAD
3733

2:00 PM
AERO / PD

45 NAIL
ROAD 16342
TALL 16344
CK 16345
16346

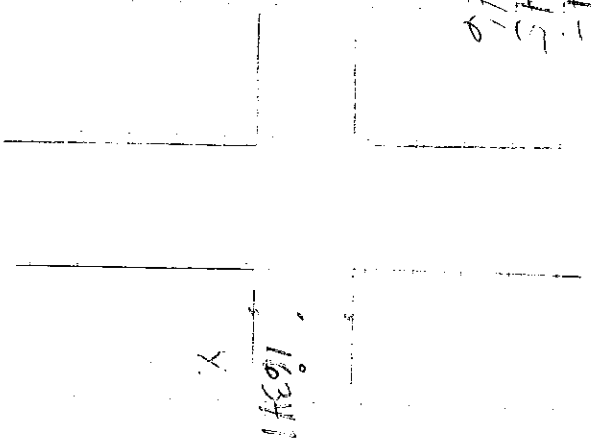

pics
3735 ROAD
3734 TA

42612 TO Agency
Sps B

42612
ROAD 16348
16350
BLDG 16351
CK 16352

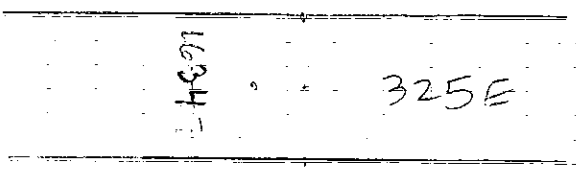

pics
3731 ROAD
3730 BLDG

3/6 AM
MP

TIP
BANK



MISSING!
Moultrie Co.

210107
AECOD / DT

72612

CP50

57111
MP

47 MAIL
ROAD 16354
- 16356
BRUSH 16357
CR 16358

48
ROAD 16360
- 16362
WOODS 16363
CR 16364

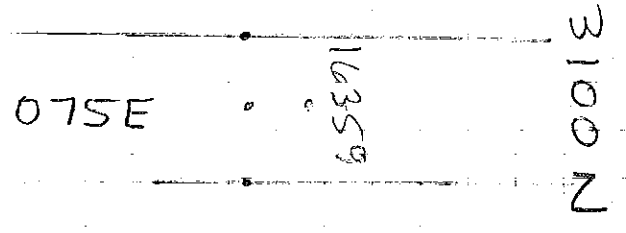
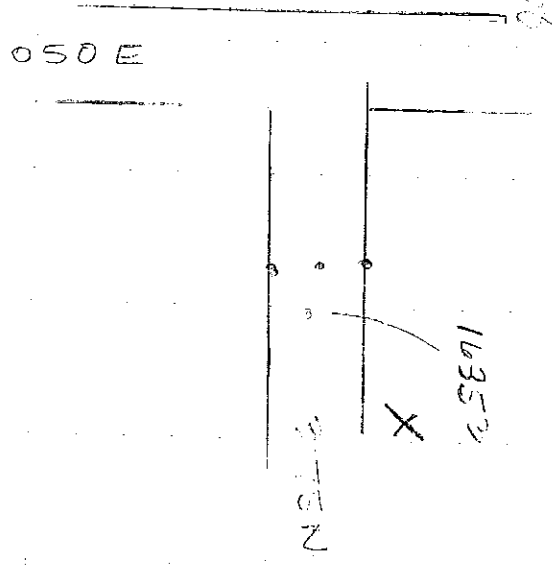

37399
3741
ROAD
BRUSH

P1C5
3742
3743
ROAD
WOODS

MISSING!
Moultrie Co.

210 211

210 211

GPS B

NE

58

17

49 NAIL
ROAD 10366

- 10368

BUSH 10369

CK 10370

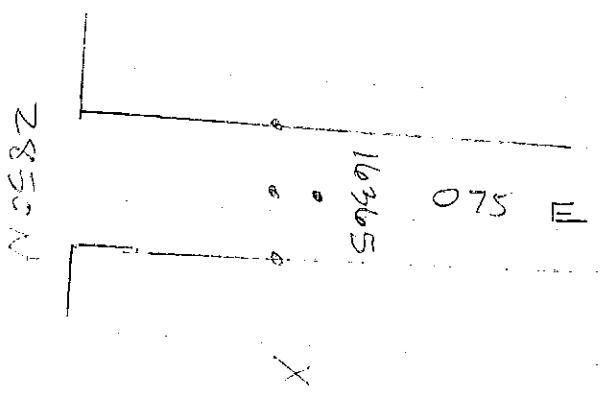

49 NAIL
ROAD 10372
- 10374
WOODS 10375
CK 10376

2955N

1160E

2

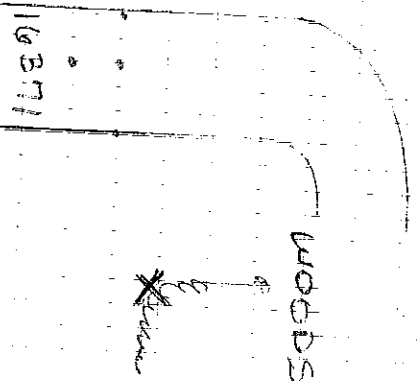

PICS
3744 ROAD
3745 BUSH

PICS
3746 ROAD
3747 WOODS

Missing!
Moultrie Co.

2-10-07
AERO/D

68/11

53NALL
ROAD 16391
- 16303
TALL 16391
OK 16303

PICS 3754 ROAD
3755 TALL

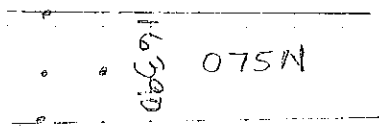

STOOD

ST. NALL
ROAD 16391
- 16390
SHOP 16392
OK 16391

PICS 3756 ROAD
3757 SHOP

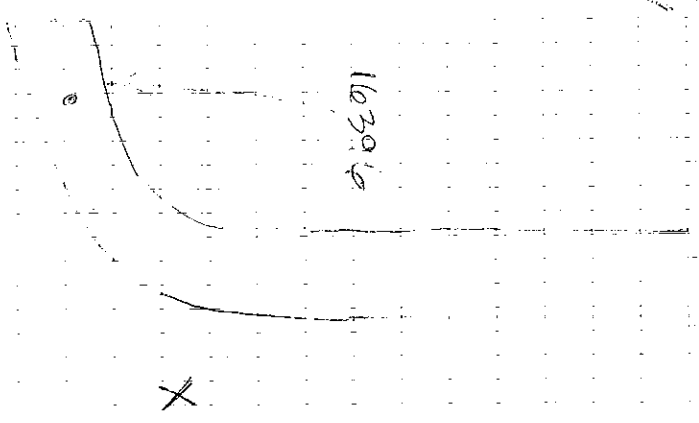

Missing!
Moultrie Co.

210107
AEGAD 107

56 MAIL
ROAD 16403
WOODS
CX 10406
10407

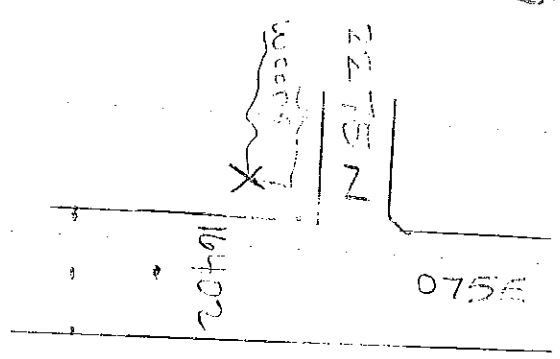

PICS 37 54
37 50
ROAD
WOODS

4.27.12

56 MAIL
ROAD 16409
TRAIL
CX 10411
10413

175E

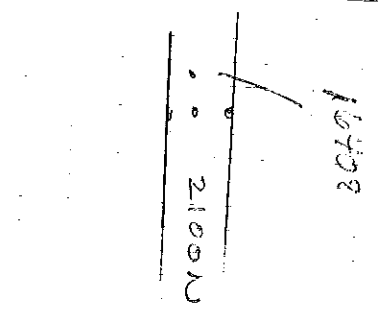

PICS 37 61
37 61
ROAD
TRAIL

GPS
107

6/1

MISSING!
Moultrie Co.

2000
MEMO

57
ROAD 10415
- 10417
- 10418
- 10419

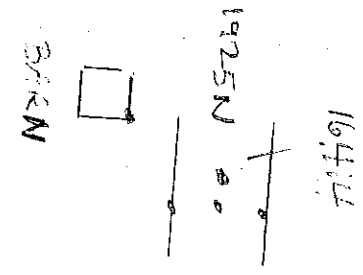

1001

P103
37102
- 37103
ROAD
5-10-06

42712
58 N K12
ROAD 10421
- 10422
BRUSH 10425
CV 10416

GPS B

MP 17

SEE FINDER
SITE FINDER

10427 LBS

5005

P105
37111
ROAD
BRUSH

