



Ground Survey

Title: GS31-01-01-03  
SURVEY STATION SKETCH

Date: 6/6/2014

Rev: 1

Page: 1

File Name: GS31-01-01-03\_SURVEY\_STATION\_SKETCH

PROJECT: 312015508 CASPER, WY

ID: CP113A

Date: 11/03/2015

Sketch Not To Scale

DESCRIPTION:

TOP CENTER OF 7" DIA FENCE POST (CORNER) ON SE'LY SIDE OF NOTCHES RD AND NE'LY OF BNSF RR ACCESS RD

APPROXIMATE COORDINATES:

LATITUDE (DDMMSS.S): 43°02'08.7"N

LONGITUDE (DDMMSS.S): 106°59'08.5"W

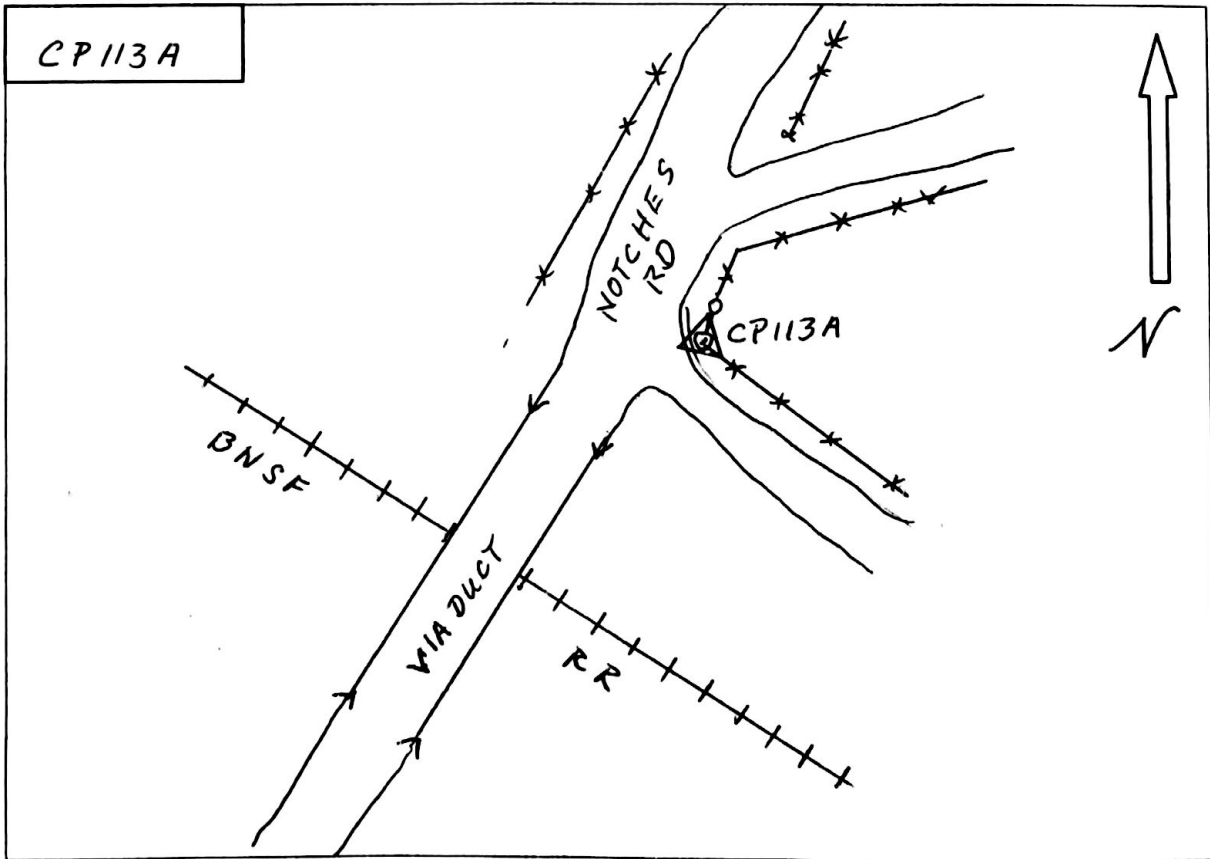

Surveyor: CHRIS LARSON